

# PROGRAM & EXHIBITS GUIDE

March 16-18

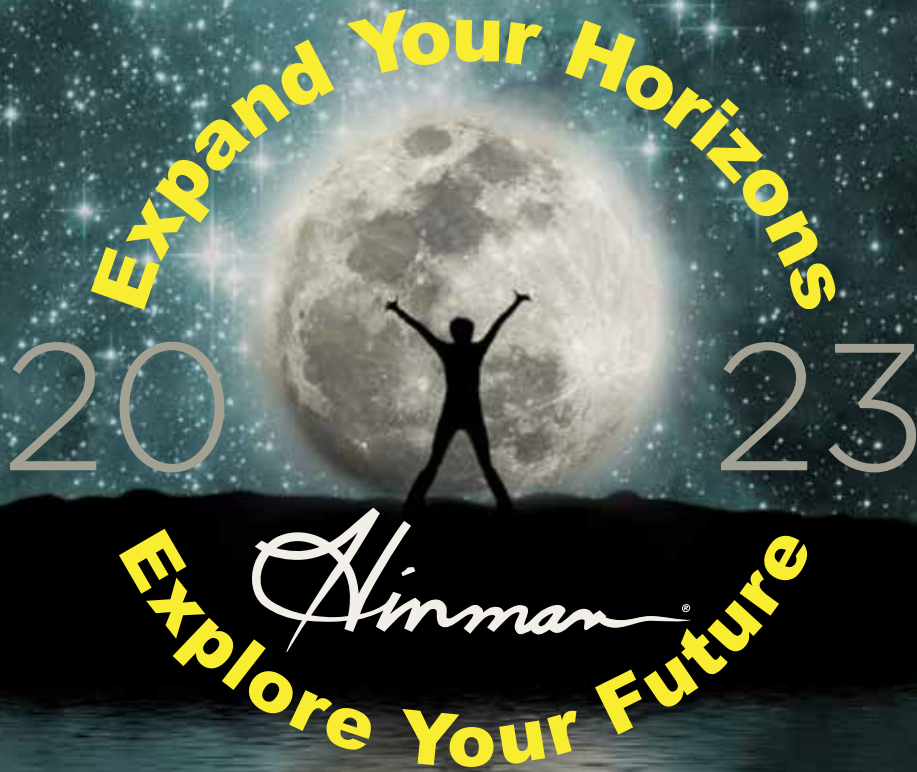

*110th Thomas P. Hinman Dental Meeting*

Georgia World Congress Center & Omni Hotel at CNN Center

Dr. Roy A. McDonald, General Chair

Dr. E. David Anderson, President

# Hinman's NIGHT OUT



AT THE  
**TABERNACLE**

Spend St. Paddy's Day with Hinman!  
*featuring*



Friday, March 17 | 7 - 10:30 p.m. | Event Fr407

## TICKETS

Tickets are \$60. Students and residents pay \$25. Meeting badge with proof of purchase must be presented for entry. All tickets must be purchased in advance. Tickets will not be available at the door. All attendees must be at least 18 years of age.

## TICKET INCLUDES

Each ticket includes access to the historic Tabernacle, a variety of food stations, prize drawings, two drink tickets (additional beverages will be available for purchase) and live music by Party Nation, who will keep the dance floor packed all night long.

---

Thank you to our party sponsor:



**CoastDental**  
& Orthodontics

Welcome

20



23

**TABLE OF CONTENTS**

Accreditation & CE Information . . . . . 19

Exhibit Hall Information. . . . . 26

Exhibit Hall Floorplan. . . . . 28-29

Exhibitors Listing. . . . . 30-39

FAQs. . . . . 19

Friday Courses . . . . . 9-12

Georgia World Congress Center (GWCC) Map . . . . . 23

Hinman History. . . . . 17

Keynote Session . . . . . 2

Learning Lab . . . . . 27

Omni Hotel Map . . . . . 24-25

Receptions and Gatherings . . . . . 16

Saturday Courses . . . . . 14-15

Shuttle Schedule . . . . . 22

Thursday Courses . . . . . 5-7

Total Health Pavilion . . . . . 27

Virtual CE . . . . . 3, 40

2024 Meeting Information . . . . . 20-21

**Expand Your Horizons...Explore Your Future at Hinman**



## Keynote Session with Dr. Nido Qubein

Earn one hour of CE by attending this session.

Thursday: 5:30 – 7 p.m. | No Fee | Event Th401 | GWCC, Sidney Marcus Auditorium

Join us for the official opening ceremony of the Hinman Dental Meeting featuring Dr. Nido Qubein. Doors and cash bar open at 5 p.m. with a musical prelude until 5:30 p.m.

### From Success to Significance

Out of adversity emerges abundance. Difficult times often are filled with opportunities.

Dr. Nido Qubein came to the United States as a teenager with little knowledge of English and only \$50 in his pocket, yet ended up a mega-success story. Today, he is president of a leading university and chairman of a national retail company—and one of the most sought-after leadership speakers. Dr. Qubein delivers an inspiring message on finding focus, balance and meaning in business and in life. You'll leave this presentation entertained and inspired to be impactfully innovative.

#### Marvin C. Goldstein Memorial Lecture

This session is sponsored by the Atlanta chapter of the Alpha Omega International Dental Fraternity in cooperation with the Thomas P. Hinman Dental Meeting. The Fraternity has dedicated this lectureship in memory of Dr. Marvin C. Goldstein.

## Separate not thyself from the community ~Ethics of the Fathers~

### DR. MARVIN C. GOLDSTEIN

Marvin C. Goldstein, D.D.S., F.A.C.D., F.I.C.D. was a product of his heritage and his faith. He was devoted to his profession and to his family—immediate and extended. A man of his community, he gave of himself unstintingly to help make it the best it could be. Marvin's philosophy about doing good things, simply put, was "because it's the right thing to do."

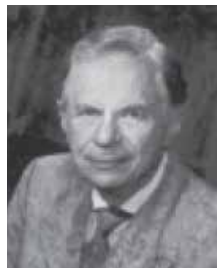

might not be completed, he knew he had to make the effort. But Marvin's greatest passion was people. His community involvement knew no bounds. Civic leaders, regardless of faith, color, gender or political persuasion, turned to him as a man of courage and conviction. It was not only for financial help but also to seek his advice and counsel on subjects ranging from practicality to those of more esoteric nature.

Active in more than 20 dental organizations, he devoted 48 years as a volunteer to the Ben Massell Dental Clinic in Atlanta where he was Chief of Staff Emeritus at the time of his death. He served as President of no less than eight dental, civic, religious or volunteer organizations, was Chairman of the board of ten such activities and participated as a worker in countless other associations. In addition to being a Clinical Professor of Orthodontics at the Medical College of Georgia School of Dental Medicine, he presented more than 200 lectures in the U.S. and abroad and contributed extensively to the literature.

His plethora of activities make the point that one does what one wants to do and that time can be found to participate in total life-cycle experiences. Though realizing that many endeavors

His efforts to assist students trying to enter schools of higher education and the professions are legend. Those concerns were outdone only by the friendship he offered as they traveled the road of life. And, yet, this plate he had been served—so full of doing and giving to and for others—always had special room for his devoted wife and helpmate, Rita, and their five children and their families.

Marvin Goldstein, whom we memorialize now and for the future, was truly "a man for all seasons"—a man for all reasons. Martin Buber, the great philosopher and theologian said, "God made no tools for himself; He needed none, for He created for Himself a partner."

Such a partner was Marvin Goldstein. No more can—or need—be said.

*These Dr. Marvin C. Goldstein Lectures, gifts to the Hinman Dental Meeting, are made possible by donations from members of the Atlanta Chapter of the Alpha Omega International Dental Fraternity, other Alpha Omega Fraters, friends and Dr. Goldstein's family.*

# EXPAND YOUR HORIZONS EVEN FURTHER.

## Explore additional CE opportunities.

The below one-hour courses are \$35 per course for registered in-person attendees and \$50 per course for virtual-only registrants. Log in to your Hinman registration account to add these courses. Courses available through May 31, 2023. Complete the five-question quiz and survey at the conclusion of the course to obtain your CE certificate.

SPEAKER	TITLE	COURSE #
Dr. Mark Murphy	Is Going Non Par the Right Move for YOU	Vr600
Ms. Nancy Dewhirst	Right Under Our Noses...Emerging & Re-Emerging Diseases	Vr601
Dr. Alan Budenz	Prevention and Minimally-Invasive Dentistry: Diminishing the Role of the Dental Drill	Vr602
Dr. James Braun	Let's Put It All Together: The Best Materials for Direct Composite Restorations	Vr603
Dr. Gordon Christensen	Getting Prepared for Future Dentistry	Vr604
Dr. Megan King	The Future of Endodontic Care	Vr605
Dr. Laura Braswell	Laser Periodontics To Enhance Optimal Patient Care	Vr606
Dr. Kevin Kwiecien	Health-Centered Dentistry in the Digital Age	Vr607
Dr. Clayton Davis	Lab Communication in a World Transitioning from Analog to Digital	Vr608
Mr. Brandon Collier	An Aggressive but Legal Approach to Taxes, With 2023 Updates	Vr609
Ms. Laci Phillips Newland	Creating New Perspectives & Opportunities: How to Explore Your Horizons and Expand Your Future in the Dental Practice	Vr610
Dr. Mark Kleive	Utilizing 3D Printing and Other Digital Integration in General Dentistry	Vr611
Dr. Wayne Kerr	How to Get to Life After Dr.	Vr612
Dr. Dan Dunwody	Outside In Facial and Oral Examination: A Key to Optimal Health	Vr613
Ms. Jo-Anne Jones	Xerostomia: Etiology, Evaluation, and Innovative Strategies to Treat	Vr614
Dr. Parag Kachalia	Overview of New Technologies with a Clear ROI	Vr615



After you add the course to your registration account, head to <https://www.prereg.net/2023/hd-virtual/> to view the course and obtain your CE certificate.



## COURSE INFORMATION Please visit the [Hinman APP](#) or [Hinman.org](#) for course descriptions.

TYPE	COURSE #	FEES	DESCRIPTION
Participation Course	100	Fees vary	Seats for these hands-on courses should be purchased in advance as space is limited.
Registered Attendance Lecture	200	Fees vary	Seats for these lectures should be purchased in advance or onsite as space is available.
Interactive Course	200	Fees vary	Seats for these discussion-based courses should be purchased in advance as space is limited.
General Attendance Lecture	300	No fee	Seats for these lectures can be selected in advance or onsite (if space is available).
Special Event	400	Fees vary	Seats for these events can be purchased or selected in advance or onsite (if space is available).

Please be sure to record your four-digit course completion code at the conclusion of each course. You will need the code and your badge number in order to process your CE certificate. Course handouts are available at [Hinman.org](#) and on the Hinman APP until April 11.

COURSE	BUILDING/ROOM	SPEAKER	TITLE	TIME
Th100	Omni/Dogwood A	Dr. Gigi Meinecke	Botox and Dermal Filler Training	8 a.m. - 5 p.m.
Th101	Omni/Dogwood A	Dr. Gigi Meinecke	Botox Refresher Course	8 a.m. - 12 p.m.
Th102	GWCC/A410	Dr. Daren Becker Dr. Lee Ann Brady Dr. Kelley Brummett Dr. Mike Crete Dr. Michael Melkers	Pankey Essentials 1	8 a.m. - 5 p.m.
Th103	GWCC/Exhibits 5	Dr. Lee Silverstein	Atraumatic Extraction and Socket Grafting for the General Practitioner*	8 - 11 a.m.
Th104	Omni/Juniper	Dr. Mark Kleive	Bite Splints in Restorative Practice	8:30 - 11 a.m.
Th105	Omni/Cottonwood	Dr. James Braun	The Latest and Best Composites and Matrices for Restorative Cases*	12 - 3 p.m.
Th106	Omni/Dogwood B	Dr. Greg Folse	Difficult Denture Patients: Real-World Solutions Hands-On Workshop*	12 - 3 p.m.
Th108	GWCC/Exhibits 1	Dr. Sam Low	Utilize Today's Dental Lasers in Managing Periodontal/ Soft Tissue Conditions in the Dental Practice: A Workshop*	12 - 3 p.m.
Th109	Omni/Walnut	Dr. Mark Murphy	Applications in Treating Sleep Apnea in Your Practice: Hands-On Workshop*	12 - 3 p.m.
Th111	GWCC/Exhibits 5	Dr. Lee Silverstein	GUMS R US Crown Lengthening: a User-Friendly Hands-On Course*	12 - 3 p.m.
Th112	Omni/Juniper	Dr. Mark Kleive	Mastering Dental Photography with Your Smartphone*	12:30 - 3 p.m.
Th200	GWCC/A302	Amber Auger Stephanie Botts Jo-Anne Jones Rachel Wall	Prevention Convention	8 a.m. - 3 p.m.
Th201	Omni/International Ballroom F	Stephanie Botts Shannon Brinker Dr. Mark Hyman Lisa Mallonee	Assisting Essentials	8 a.m. - 3 p.m.
Th202	GWCC/A313	Lois Banta	Top 10 Management Tools for a Successful Practice	8 - 11 a.m.
Th203	GWCC/A312	Kirk Behrendt	The Best Practices to Increased Treatment Acceptance	8 - 11 a.m.
Th204	GWCC/A404	Dr. James Braun	Direct Composites: New Products and Equipment for Optimum Results	8 - 11 a.m.
Th205	Omni/International Ballroom D	Dr. Gordon Christensen	The Christensen Bottom Line 2023	8 - 11 a.m.
Th206	GWCC/A314	Dr. Greg Folse	Difficult Denture Patients: Real-World Solutions	8 - 11 a.m.
Th207	GWCC/A405	Dr. Joel Laudenbach	Oral Cancer Screening and Lesion Recognition	8 - 11 a.m.
Th208	GWCC/A407	Dr. Sam Low	Successful Tactics in Managing Peri-Implant Diseases	8 - 11 a.m.
Th209	GWCC/A403	Dr. Ben Miraglia	Childhood Sleep Disordered Breathing: The Dental Team's Role: Part 1	8 - 11 a.m.
Th210	GWCC/A409	Dr. Mark Murphy	Introduction to Treating Sleep Apnea in Your Practice: From Getting Started to Medical Billing*	8 - 11 a.m.
Th211	GWCC/A315	Dr. Jeff Okeson	What Every Dentist Should Know About TMD: Part 1	8 - 11 a.m.
Th212	GWCC/A304	Tom Viola	"Medical History Mastery!": Decipher The Clues, Avoid Complications and Treat Your Medically Complex Patients!	8 - 11 a.m.

\*REPEATED COURSE | Note: Course list is subject to change.

# THURSDAY MARCH 16

< CONTINUED FROM PREVIOUS PAGE

COURSE	BUILDING/ROOM	SPEAKER	TITLE	TIME
Th213	GWCC/A401	Dr. Nader Sharifi	Controversies in Restorative Implant Dentistry	8 - 11 a.m.
Th214	GWCC/A316	Dr. Mike Pruett	Conscious Sedation Permit Update*	8 a.m. - 12 p.m.
Th215	GWCC/A406	Minal Sampat	The Internal Marketologist: Build Your Custom Marketing Plan	9 - 10:30 a.m.
Th216	GWCC/A311	Laci Phillips Newland	Communications, Coding and Collections: The Three Cs of the Profitable Practice	9 - 11 a.m.
Th217	Omni/International Ballroom C	Charles Loretto	Creating a Successful Dental Transition: Lessons Learned from 35 Years of Practice Transitions	9 - 11 a.m.
Th218	Check App	Dr. Bo Bruce	Occlusion "SIMPLIFIED": Making Everyday Occlusion Easy and Predictable	9 a.m. - 12 p.m.
Th219	GWCC/A303	Dr. Hal Crossley Dr. Mitch Gardiner	Changing Standards of Care 2023: Practice in the Present and Protect Your Patients	9 a.m. - 12 p.m.
Th220	GWCC/A402	Dr. Glenn Maron	Medical Emergencies in the Dental Office	9 a.m. - 12 p.m.
Th221	Omni/Chestnut	Dr. Linda Niessen	Caring for Medically Complex Older Adults	9 a.m. - 12 p.m.
Th222	GWCC/A310	Dr. John Droter	Common TMDs You Can Treat in a General Practice	9 a.m. - 12 p.m.
Th223	GWCC/A311	Lois Banta	Total Team Concept for Effective Scheduling	12 - 3 p.m.
Th224	GWCC/A304	Kirk Behrendt	The Best Practices to a Better Life in Dentistry	12 - 3 p.m.
Th225	Omni/International Ballroom AB	Dr. Alan Budenz	Numb, Number, Numbest: Updates on Local Anesthesia	12 - 3 p.m.
Th226	GWCC/A314	Dr. Gordon Christensen	Esthetic Dentistry - 2023	12 - 3 p.m.
Th227	GWCC/A313	Bruce Christopher	Are We Having Fun Yet? Attitude and Peak Performance in the Practice	12 - 3 p.m.
Th228	GWCC/A312	Dr. David Clark	21st Century Composites: Stop Layering and Start Injection Molding!	12 - 3 p.m.
Th229	Omni/International Ballroom D	Nancy Dewhirst	Annual OSHA Training and Infection Control: Are We Safe "Enough"?*	12 - 3 p.m.
Th230	GWCC/A407	Dr. Randy Huffines	Successfully Treating Older Adults: Techniques for the Entire Dental Team	12 - 3 p.m.
Th231	GWCC/A315	Dr. Jeff Okeson	What Every Dentist Needs to Know About the Management of TMD: Part 2	12 - 3 p.m.
Th232	GWCC/A405	Dr. Nader Sharifi	A Partial Course on Partial Dentures	12 - 3 p.m.
Th233	GWCC/A404	Tom Viola	"Are We Still Working The Bugs Out?!" Prescribing Anti-Infectives and Navigating New Antibiotic Prophylaxis Guidelines	12:30 - 2:30 p.m.
Th234	GWCC/A402	Dr. Mitch Gardiner	The Periodontal Ligament Injection for Mandibular Local Anesthesia: Say Goodbye to the Mandibular Block for Most of Your Restorative Dentistry*	1 - 3 p.m.
Th235	GWCC/A403	Dr. Glenn Maron	Ethics, Medical Legal Issues in Dentistry: What Dentists Need to Know about the New Rules and Laws*	1 - 3 p.m.
Th236	GWCC/A316	Dr. Ben Miraglia	Childhood Sleep Disordered Breathing: The Dental Team's Role: Part 2	1 - 3 p.m.
Th300	Omni/International Ballroom E	Jo-Anne Jones	Hindsight is 20/20: Missing the Oral/Oropharyngeal Cancer Diagnosis*	8 - 10:30 a.m.
Th301	Omni/Grand Ballroom A-D1	Bruce Christopher	The Psychology of Success: Secrets the Superstars Know	8 - 11 a.m.
Th302	GWCC/A411	Dr. Randy Huffines	Autoimmune Disease and Dentistry	8 - 11 a.m.
Th303	GWCC/A305	Dr. Larry Williams	Geriatric Dentistry: Treatment Planning, Treatment Concerns and Communication	8 - 11 a.m.
Th304	Omni/Grand Ballroom D2-E	Lisa Mallonee	Size Matters: Obesity and Periodontal Health	9 a.m. - 12 p.m.
Th305	GWCC/A412	Dr. John Svirsky	Cases Only a Mother Could Love	9 a.m. - 12 p.m.
Th306	 GWCC	Ryan Vet	Cracking the Millennial Code: Decoding the Generations to Effectively Motivate and Manage Millennials	10 - 11:30 a.m.
Th307	 GWCC	Gary Salman	10 Ways to Build a Ransomware Resilient Practice*	12 - 1:30 p.m.
Th308	Omni/International Ballroom E	Minal Sampat	The Social Marketologist: Learn to Master Social Media	12 - 1:30 p.m.
Th309	GWCC/Sidney Marcus Aud.	Dr. Mark Hyman	The Top 20 Game-Changers of 2023	12 - 3 p.m.
Th310	GWCC/A305	Dr. Kevin Kwicien	Health-Centered Dentistry - Team-Centered Systems*	12 - 3 p.m.
Th311	Omni/Grand Ballroom A-D1	Dr. Larry Williams	Tobacco, Vaping and Cannabis: What Do You Know?*	1 - 2:30 p.m.
Th312	GWCC/A411	Amber Auger	It's Not You: It's Your Saliva*	1 - 3 p.m.
Th313	Omni/Grand Ballroom D2-E	Laci Phillips Newland	Creating Leaders in Your Practice: Three Key Systems to a Perfect Team	1 - 3 p.m.
Th314	 GWCC	Dr. Amy Dayries-Ling	An Integrative Approach to Dentistry: Connecting Whole Body Health in the Hygiene Chair	2 - 3:30 p.m.



COURSE	BUILDING/ROOM	SPEAKER	TITLE	TIME
Th368	 GWCC	Pras Murthy	How To Grow Your Practice (and Your Online Presence)	10 - 11 a.m.
Th369	 GWCC	Pras Murthy	Marketing Your Practice in the Age of Convenience	11:30 a.m. - 12:30 p.m.
Th370	 GWCC	Dr. Sam Shamardi	Impactful Homecare Improvements for Healing and Maintenance around Implants*	1 - 2 p.m.
Th371	 GWCC	Dr. Len Tau	Raving Patients: Get Visible, Get Credible: Get More New Patients	2:30 - 3:30 p.m.
Th372	 GWCC	Dr. Gregori Kurtzman	Oral Biofilm: The Systemic Effects - How to Manage Clinically & With Homecare	4 - 5 p.m.
Th380	Omni/Hazelnut	Dr. David Rothman	The Myths of Pediatric Dentistry	10 a.m. - 12 p.m.

### SPECIAL EVENTS

Th400	AmericasMart		AmericasMart Shopping*	10 a.m. - 4 p.m.
Th401	GWCC/Sidney Marcus Auditorium		Keynote Session with Dr. Nido Qubein	5:30 - 7 p.m.

\*REPEATED COURSE | Note: Course list is subject to change.

## GET the Hinman APP!

Manage your registration account on the go and access these features in real time:



- ✓ Course Room Locations
- ✓ Exhibitor Lists, Floor Plans and Show Specials
- ✓ Maps of the GWCC and Omni
- ✓ CE Verification  
(avoid the lines and email certificates to print from home)
- ✓ Add Courses and Special Events Onsite



thank you to our APP sponsor



WiFi in the GWCC is provided by





## COURSE INFORMATION Please visit the [Hinman APP](#) or [Hinman.org](#) for course descriptions.

TYPE	COURSE #	FEES	DESCRIPTION
Participation Course	100	Fees vary	Seats for these hands-on courses should be purchased in advance as space is limited.
Registered Attendance Lecture	200	Fees vary	Seats for these lectures should be purchased in advance or onsite as space is available.
Interactive Course	200	Fees vary	Seats for these discussion-based courses should be purchased in advance as space is limited.
General Attendance Lecture	300	No fee	Seats for these lectures can be selected in advance or onsite (if space is available).
Special Event	400	Fees vary	Seats for these events can be purchased or selected in advance or onsite (if space is available).

Please be sure to record your four-digit course completion code at the conclusion of each course. You will need the code and your badge number in order to process your CE certificate. Course handouts are available at [Hinman.org](#) and on the Hinman APP until April 11.

COURSE	BUILDING/ROOM	SPEAKER	TITLE	TIME
Fr100	Omni/Dogwood A	Dr. Gigi Meinecke	Botox and Dermal Filler Training	8 a.m. - 5 p.m.
Fr102	GWCC/A410	Dr. Daren Becker Dr. Lee Ann Brady Dr. Kelley Brummett Dr. Michael Crete Dr. Michael Melkers	Pankey Essentials I	8 a.m. - 5 p.m.
Fr113	Check App	Dr. Michael Pruet	Introduction to Implant Dentistry: Hands-On Placement with Models	8 a.m. - 4 p.m.
Fr114	Omni/Dogwood A	Dr. Gigi Meinecke	Dermal Filler Refresher Course	8 a.m. - 12 p.m.
Fr115	GWCC/Exhibits 1	Dr. Samuel Low	Utilize Today's Dental Lasers in Managing Periodontal/Soft Tissue Conditions in the Dental Practice: A Workshop*	8 - 11 a.m.
Fr116	Omni/Juniper	Dr. Mark Kleive	Mastering Dental Photography with Your Smartphone*	8:30 - 11 a.m.
Fr117	Omni/Magnolia	Dr. David Rothman	Pulp and What Else?: Treatment Options for Primary Molars Workshop	8:30 - 11:30 a.m.
Fr118	Omni/Cottonwood	Dr. James Braun	The Latest and Best Composites and Matrices for Restorative Cases*	9 a.m. - 12 p.m.
Fr119	Omni/Dogwood B	Dr. Gregory Fols	Difficult Denture Patients: Real-World Solutions Hands-On Workshop*	9 a.m. - 12 p.m.
Fr120	Check App		Cardiopulmonary Resuscitation Re-Certification (CPR)*	9 a.m. - 12 p.m.
Fr121	GWCC/Exhibits 2	Reneé Graham	Ultrasonic Instrumentation: The Science of Technology to Advance Your Technique	9:30 - 11:30 a.m.
Fr122	Omni/Redwood	Dr. David Clark	Modern Monolithic Injection Molded Composite Dentistry*	9:30 a.m. - 12:30 p.m.
Fr123	GWCC/Exhibits 3	Shannon Brinker	Digital Workflow For The Dental Assistant	9:30 a.m. - 12:30 p.m.
Fr124	GWCC/Exhibits 5	Dr. Lee Silverstein	GUMS R US Crown Lengthening: a User-Friendly Hands-On Course*	9:30 a.m. - 12:30 p.m.
Fr126	Omni/Walnut	Dr. Mark Murphy	Applications in Treating Sleep Apnea in Your Practice: Hands-On Workshop*	12 - 3 p.m.
Fr127	GWCC/Exhibits 2	Reneé Graham	Exposing the Experts in Radiology: The Science of Technology to Advance Your Technique*	
Fr128	GWCC/Exhibits 1	Dr. Laura Braswell	Try Before You Buy! How to Choose the Right Laser for Your Dental Practice* 1 - 4 p.m.	
Fr129	Omni/Sycamore	Diane Millar	Advanced Reinforced Scaling and Ergonomics: Elevate Your Career to a New Level!*	1 - 4 p.m.
Fr130	Omni/Redwood	Dr. David Clark	Modern Monolithic Injection Molded Composite Dentistry*	1:30 - 4:30 p.m.
Fr131	Omni/Magnolia	Dr. Alan Budenz	X Marks the Spot: Local Anesthesia Techniques Simulation Hands-On Workshop*	1:30 - 4:30 p.m.
Fr132	Check App		Cardiopulmonary Resuscitation Re-Certification (CPR)*	1:30 - 4:30 p.m.
Fr133	Omni/Oak	Dr. Neil Warshawsky	Learning to Print in 3D: A Hands on Step-by-Step Approach to 3D Printing in Dentistry*	
Fr134	GWCC/Exhibits 5	Dr. Lee Silverstein	Atraumatic Extraction and Socket Grafting for the General Practitioner*	2 - 4:30 p.m.
Fr135	Check App	Dr. William Bruce	Veneer Prep "BLUEPRINT" Workshop - From Prep to Provisionals	12 - 3 p.m.

\*REPEATED COURSE | Note: Course list is subject to change.

# FRIDAY MARCH 17

< CONTINUED FROM PREVIOUS PAGE



COURSE	BUILDING/ROOM	SPEAKER	TITLE	TIME
Fr237	GWCC/A401	Dr. Shahrokh Bagheri Dr. William Bruce Dr. Alan Budenz Dr. Mark Kleive	Clinician Fast Track	8 a.m. - 3 p.m.
Fr238	Omni/International Ballroom D	Lois Banta Kirk Behrendt Dr. Mark Hyman Laci Phillips Newland	Business Office Bonanza	8 a.m. - 3 p.m.
Fr239	Omni/International Ballroom E	Dr. Gordon Christensen	Dr. Christensen's Most Frequent Failures and How to Avoid Them	8 - 11 a.m.
Fr240	Omni/Hazelnut	Dr. Kevin Donly	Contemporary Pediatric Restorative Dentistry-Minimally Invasive to Comprehensive Care*	8 - 11 a.m.
Fr241	GWCC/A316	Dr. Mitchell Gardiner	Your Dental Team Can Defend You From Malpractice: Teach Them How	8 - 11 a.m.
Fr242	GWCC/A304	Dr. Mark Murphy	Introduction to Treating Sleep Apnea in Your Practice: From Getting Started to Medical Billing*	8 - 11 a.m.
Fr243	GWCC/A403	Thomas Viola	"I Hated Pharmacology in School!" [...But Now I Wish I Remembered It!]	8 - 11 a.m.
Fr244	Omni/Sycamore	Dr. Pat Little	A Secret Pay Raise: How Embezzlers Think and Act	8:30 - 11 a.m.
Fr245	Check App	Dr. Shahrokh Bagheri	Trigeminal Nerve Injuries from Dental Implants and Oral Surgery	9 - 10:30 a.m.
Fr246	GWCC/A402	Lois Banta	Huddles and Team Meetings That Work	9 - 11 a.m.
Fr247	GWCC/A406	Jo-Anne Jones	It's Showtime! The Life of a Dental Professional	9 - 11 a.m.
Fr248	Omni/International Ballroom C	Rachel Wall	Powerful Partnership: Build Strong Dentist-Hygiene Collaboration for a Thriving Practice	9 - 11 a.m.
Fr249	GWCC/A315	Dr. Larry Williams	Medical Emergencies in the Dental Practice	9 - 11 a.m.
Fr250	GWCC/A408	Dr. Neil Warshawsky	Digital Workflow: What is it, Why is it Important and What Does it Take to Create It?	9 - 11:30 a.m.
Fr251	GWCC/A311	Amber Auger	What Lies Beneath: Treating Periodontal Disease Systemically	9 a.m. - 12 p.m.
Fr252	GWCC/A409	Dr. Steven LoCascio	Achieving Predictable Results In The Aesthetic Zone With Dental Implants	9 a.m. - 12 p.m.
Fr253	GWCC/A303	Dr. Nader Sharifi	Uppers are From Mars, Lowerers are From Venus: Clarifying Overdentures	9 a.m. - 12 p.m.
Fr254	GWCC/A310	Dr. John Olmsted	Exploring New Endodontic Technology	9 a.m. - 12 p.m.
Fr255	Omni/Hickory	Dr. John Droter	Let's See What That Clicking Sound Is All About	9 a.m. - 12 p.m.
Fr256	Omni/Chestnut	Lisa Mallonee	WARNING: Being Female May Be Hazardous to Your Health! Women, Nutrition and Oral Health: Implications Throughout the Lifecycle	9:30 - 11 a.m.
Fr257	GWCC/A405	Dr. Mark Hyman	A Day In The Life of a TOP GUN Dental Team	12 - 3 p.m.
Fr258	Omni/International Ballroom C	Dr. Pat Little	HIPAA Security Rule, Data Breaches and Identity Theft: Don't Get Bitten	12:30 - 3 p.m.
Fr259	GWCC/A403	Dr. Mitchell Gardiner	The Periodontal Ligament Injection for Mandibular Local Anesthesia: Say Goodbye to the Mandibular Block for Most of Your Restorative Dentistry*	1 - 3 p.m.
Fr260	GWCC/A406	Charles Loretto	The First 10 Years: A Bridge to Financial Freedom	1 - 3 p.m.
Fr261	GWCC/A304	Dr. James Braun	Lab Cad-Cam Crowns: The Best Dentists Can Offer Their Patients	1 - 4 p.m.
Fr262	GWCC/A303	Dr. Randy Huffines	Restorative Challenges in Older Adults	1 - 4 p.m.
Fr263	GWCC/A310	Dr. Wayne Kerr	Key Elements for Practice Success!	1 - 4 p.m.
Fr264	GWCC/A407	Dr. John Svirsky	25 Shades of Grey and a Whole Lot Less Risque	1 - 4 p.m.
Fr265	Omni/International Ballroom AB	Dr. John Olmsted	Expanding Your Knowledge of Endodontics	1 - 4 p.m.
Fr266	GWCC/A404	Dr. Harold Crossley	Opioid Use, Misuse, Abuse and Addiction: Appropriate Opioid and Non-Opioid Prescribing	2 - 4 p.m.
Fr267	GWCC/A402	Dr. Glenn Maron	Medical Update for Dentistry: From Bisphosphonates to Blood Thinners	2 - 4 p.m.
Fr275	Omni/Oak	Nancy Dewhirst	Infection Control Workshop: What Works?	9 a.m. - 12 p.m.

\*REPEATED COURSE | Note: Course list is subject to change.

# FRIDAY MARCH 17

COURSE	BUILDING/ROOM	SPEAKER	TITLE	TIME
Fr276	GWCC/Exhibits 3	Shannon Brinker	Dental Assistant Products Showcase	1:30 - 4:30 p.m.
Fr315	Omni/Grand Ballroom D2-E	Stephanie Botts	The Dental Professional's Role in Supporting Patients with Substance Use Disorder	8 - 11 a.m.
Fr316	GWCC/A411	Dr. Jeffrey Okeson	The Non-Odontogenic Toothache	8 - 11 a.m.
Fr317	GWCC/A312	Minal Sampat	Reeling into the Now: Conquer Instagram	9 - 10:30 a.m.
Fr318	GWCC/A405	Charles Loretto	Understanding Private Equity Offers: Sorting Through the Truth, Lies, Opportunities and Threats	9 - 11 a.m.
Fr319	GWCC/A404	Diane Millar	Sharpen Your Skills Virtually to Improve Your Competency: Elevate Your Career To a New Level!	9 - 11:30 a.m.
Fr320	GWCC/A302	Bruce Christopher	Why are Women so Strange and Men so Weird? How to Communicate Effectively with the Opposite Sex	9 a.m. - 12 p.m.
Fr321	GWCC/A412	Dr. Harold Crossley	The New Street Drugs and Their Impact on Your Patients	9 a.m. - 12 p.m.
Fr322	GWCC/Sidney Marcus Aud.	Dr. Amy Dayries-Ling	Holistic Dentistry: Practical Approaches Uniting Evidence with Popular Trends	9 a.m. - 12 p.m.
Fr323	GWCC/A314	Dr. Randy Huffines	Xtreme Prevention in Older Adults	9 a.m. - 12 p.m.
Fr324	GWCC/A313	Dr. Kevin Kwicien	Health-Centered Dentistry - Team-Centered Systems*	9 a.m. - 12 p.m.
Fr325	Omni/International Ballroom AB	Dr. Ben Miraglia	Benefits of Clear Aligner Therapy Relating to Airway/Overall Health	9 a.m. - 12 p.m.
Fr326	GWCC/A305	Dr. Glenn Maron	Oral Surgery for the General Dentist	9 a.m. - 12 p.m.
Fr327	GWCC/A407	Dr. Linda Niessen	Successful Aging: Oral Health for the Prime of Life	9 a.m. - 12 p.m.
Fr328	Omni/Grand Ballroom A-D1	Dr. John Svirsky	Oral Pathology Playhouse: Name that Disease and Other Party Games*	9 a.m. - 12 p.m.
Fr329	Omni/International Ballroom F	Laci Phillips Newland	Your Practice Through The Patient's Eyes	10 a.m. - 12 p.m.
Fr330	 GWCC	Gary Salman	10 Ways to Build a Ransomware Resilient Practice*	12 - 1:30 p.m.
Fr331	Omni/Grand Ballroom D2-E	Dr. Kevin Donly	An Update on Remineralizing Agents and Prevention	12 - 3 p.m.
Fr332	GWCC/A411	Dr. Joel Laudenbach	Oral Manifestations and Clinical Implications of Systemic Diseases	12 - 3 p.m.
Fr333	GWCC/A312	Thomas Viola	"One Pill Good, Two Pills Better?": How Our Patients Now Medicate Themselves in This Post-Pandemic World	12:30 - 2:30 p.m.
Fr334	GWCC/A302	Lisa Mallonee	Nutrition Myths, Diet Fallacies and Magical Unicorns: Oh MY!	1 - 2:30 p.m.
Fr335	GWCC/A316	Minal Sampat	Why Your Marketing is Killing Your Business, and What To Do About It	1 - 2:30 p.m.
Fr336	Omni/International Ballroom E	Kirk Behrendt	The Best Practices to Motivate Your Team	1 - 4 p.m.
Fr337	GWCC/Sidney Marcus Aud.	Bruce Christopher	Bambi vs. Godzilla: How to Deal With Difficult People	1 - 4 p.m.
Fr338	GWCC/A305	Nancy Dewhirst	Ergonomics: It's a Balancing Act	1 - 4 p.m.
Fr339	GWCC/A412	Dr. John Droter	Why Are You Clenching and Grinding Your Teeth?	1 - 4 p.m.
Fr340	GWCC/A313	Dr. Steven LoCascio	Using the TEAM Approach and Digital Planning to Achieve Predictable Results with Endosseous Implant Rehabilitations	1 - 4 p.m.
Fr341	Omni/International Ballroom F	Dr. Linda Niessen	Women's Oral Health	1 - 4 p.m.
Fr342	GWCC/A311	Dr. David Rothman	Can You Really Save That (and Why Would You?): Treatment Options for Carious Primary Teeth	1 - 4 p.m.
Fr343	GWCC/A314	Ryan Vet	Creating Experiences Worth Sharing: How to Simply Boost Patient Experience and Maximize Practice Growth	1 - 4 p.m.
Fr344	Omni/Grand Ballroom A-D1	Rachel Wall	Benchmarks, Barriers and Breakthroughs: Behind the Scenes Strategies for a Successful Hygiene Department	1 - 4 p.m.
Fr345	GWCC/A315	Dr. Gregory Folse	Treating Aging America: Time to "Doctor Up!"	1:30 - 3 p.m.
Fr346	 GWCC	Dr. Larry Williams	Tobacco, Vaping and Cannabis: What Do You Know?*	2 - 3:30 p.m.
Fr373	 GWCC	Dr. Sam Shamardi	Impactful Homecare Improvements for Healing and Maintenance around Implants*	10 - 11 a.m.
Fr374	 GWCC	Dr. Jose Marcano	Drill-Free Implantology: Magnetic Dynamic Technology for Minimally-Invasive Procedures	11:30 a.m. - 12:30 p.m.

< CONTINUED FROM PREVIOUS PAGE

COURSE	BUILDING/ROOM	SPEAKER	TITLE	TIME
Fr376	 GWCC	Dr. Leonard Tau	OMG I Got A Bad Review. What Should I Do?	1 - 2 p.m.
Fr377	 GWCC	Ray Berk	Path to Practice Ownership	2:30 - 3:30 p.m.
Fr378	 GWCC	Brandon Bosch	Dental Marketing Best Practices	4 - 5 p.m.
Fr379	 GWCC		New Product Symposium	10 - 11 a.m.

### SPECIAL EVENTS

Fr402	AmericasMart		AmericasMart Shopping*	10 a.m. - 4 p.m.
Fr403	Omni/Top Draft		Wine Tasting and Seminar with Michael Gallant	3 - 4:30 p.m.
Fr407	The Tabernacle		Hinman's Night Out at the Tabernacle	7 - 10:30 p.m.

\*REPEATED COURSE | Note: Course list is subject to change.

Receptions & Gatherings listed on page 16.

## Share Your Experience at Hinman!

Tag us at @hinmandental    | #myhinman





## COURSE INFORMATION Please visit the [Hinman APP](#) or [Hinman.org](#) for course descriptions.

TYPE	COURSE #	FEES	DESCRIPTION
Participation Course	100	Fees vary	Seats for these hands-on courses should be purchased in advance as space is limited.
Registered Attendance Lecture	200	Fees vary	Seats for these lectures should be purchased in advance or onsite as space is available.
Interactive Course	200	Fees vary	Seats for these discussion-based courses should be purchased in advance as space is limited.
General Attendance Lecture	300	No fee	Seats for these lectures can be selected in advance or onsite (if space is available).
Special Event	400	Fees vary	Seats for these events can be purchased or selected in advance or onsite (if space is available).

Please be sure to record your four-digit course completion code at the conclusion of each course. You will need the code and your badge number in order to process your CE certificate. Course handouts are available at [Hinman.org](#) and on the Hinman APP until April 11.

COURSE	BUILDING/ROOM	SPEAKER	TITLE	TIME
Sa100	Omni/Dogwood A	Dr. Gigi Meinecke	Botox and Dermal Filler Training	8 a.m. - 1 p.m.
Sa102	GWCC/A410	Dr. Daren Becker Dr. Lee Ann Brady Dr. Kelley Brummett Dr. Michael Crete Dr. Michael Melkers	Pankey Essentials I	8 a.m. - 5 p.m.
Sa136	Omni/Oak	Dr. Neil Warshawsky	Learning to Print in 3D: A Hands on Step-by-Step Approach to 3D Printing in Dentistry	9 - 11 a.m.
Sa137	Omni/Check App	Dr. William Bruce II	Composite "STREAMLINED" for Anterior & Posterior Restorations-Workshop	9 a.m. - 12 p.m.
Sa138	Check App	Dr. Alan Budenz	X Marks the Spot: Local Anesthesia Techniques Simulation Hands-On Workshop	9 a.m. - 12 p.m.
Sa139	Omni/Walnut	Dr. John Droter	CBCT/MRI Scans of the TMJ: How to Read, Interpret and Utilize Modern Imaging Techniques	9 a.m. - 12 p.m.
Sa140	Omni/Dogwood B	Dr. Kevin Kwiecien	Systematic Treatment Planning for Predictability and Confidence	9 a.m. - 12 p.m.
Sa141	Omni/Sycamore	Diane Millar	Advanced Reinforced Scaling and Ergonomics: Elevate Your Career to a New Level!	9 a.m. - 12 p.m.
Sa142	Omni/Cottonwood	Dr. John Olmsted	Excellent and Efficient Endodontic Workshop	9 a.m. - 12 p.m.
Sa143	GWCC/Exhibits 2	Reneé Graham	Exposing the Experts in Radiology: The Science of Technology to Advance Your Technique	9:30 - 11:30 a.m.
Sa144	GWCC/Exhibits 5	Dr. Lee Silverstein	Suturing for the General Practitioner and Surgical Staff	9:30 a.m. - 12 p.m.
Sa146	GWCC/Exhibits 3	Shannon Brinker	Provisionals Made Easy	9:30 a.m. - 12:30 p.m.
Sa147	GWCC/Exhibits 5	Dr. Lee Silverstein	Suturing for DENTAL STUDENTS ONLY	1 - 3 p.m.
Sa148	Omni/Cottonwood	Dr. John Olmsted	Excellent and Efficient Endodontic Workshop	1 - 4 p.m.
Sa268	GWCC/A407	Dr. Michael Pruett	Conscious Sedation Permit Update	8 a.m. - 12 p.m.
Sa269	GWCC/A401	Dr. Harold Crossley	Clues to Your Patients' Health: The Most Common Physician-Prescribed Medications	9 - 11 a.m.
Sa270	Omni/International Ballroom C	Dr. Glenn Maron	Ethics, Medical Legal Issues in Dentistry: What Dentists Need to Know about the New Rules and Laws	9 - 11 a.m.
Sa271	GWCC/A403	Nancy Dewhirst	Annual OSHA Training and Infection Control: Are We Safe "Enough"?	9 a.m. - 12 p.m.
Sa272	GWCC/A406	Dr. Kevin Donly	Contemporary Pediatric Restorative Dentistry-Minimally Invasive to Comprehensive Care	9 a.m. - 12 p.m.
Sa273	GWCC/A316	Dr. Steven LoCascio	Strategies for Implant Assisted and Supported Complete Prostheses	9 a.m. - 12 p.m.
Sa274A	GWCC/A412	Dr. Mark Hyman Charles Loretto	Practice Ownership Program for Students, Residents and New Dentists	9 a.m. - 2 p.m.
Sa274B	GWCC/A412	Dr. Mark Hyman Charles Loretto	Practice Ownership Program for Dental Practice Owners	12 - 2 p.m.
Sa277	GWCC/Exhibits 1	Rachel Wall	Lifesaving Screenings: How Dental Teams Save Lives in Simple But Powerful Ways	9 a.m. - 12 p.m.



COURSE	BUILDING/ROOM	SPEAKER	TITLE	TIME
Sa347	GWCC/A304	Ryan Vet	Lessons Learned from Stirring Lemonade to Running a \$100 Million Company	8 - 10:30 a.m.
Sa348	Omni/International Ballroom D	Kirk Behrendt	The Best Practices to Get Off of PPOs and Have More Freedom	8 - 11 a.m.
Sa349	GWCC/A312	Dr. Shahrokh Bagheri	Major Complications of Minor Oral Surgery	9 - 10:30 a.m.
Sa350	GWCC/A305	Amber Auger	It's Not You: It's Your Saliva	9 - 11 a.m.
Sa351	Omni/International Ballroom F	Jo-Anne Jones	Hindsight is 20/20: Missing the Oral/Oropharyngeal Cancer Diagnosis	9 - 11:30 a.m.
Sa352	GWCC/A411	Dr. David Clark	The Epidemic of Cracked Teeth: New Science of Strong Teeth	9 a.m. - 12 p.m.
Sa353	GWCC/A302	Dr. Mitchell Gardiner	Medical History and Informed Consent: Without a Complete Medical History and Valid Informed Consent You are Playing Russian Roulette!	9 a.m. - 12 p.m.
Sa354	GWCC/A405	Dr. Mark Kleive	Wealth Accumulation for Every Stage of Your Dental Career	9 a.m. - 12 p.m.
Sa355	GWCC/A315	Dr. Pat Little	Dental Business Dynamics	9 a.m. - 12 p.m.
Sa356	Omni/Grand Ballroom D2-E	Dr. Samuel Low	The Holistic Approach to Manage Today's Periodontal Patient	9 a.m. - 12 p.m.
Sa357	Omni/International Ballroom E	Dr. Ben Miraglia	Teen and Adult Sleep Disordered Breathing: The Dental Team's Role Part	9 a.m. - 12 p.m.
Sa358	Omni/Grand Ballroom A-D1	Dr. John Svirsky	Oral Pathology Playhouse: Name that Disease and Other Party Games	9 a.m. - 12 p.m.
Sa359	GWCC/A303	Thomas Viola	"Oh, The Pain Of It All!": Pain and Fear Keep Your Patient Away. Can You Win Them Back?	9 a.m. - 12 p.m.
Sa360	Omni/International Ballroom AB	Dr. David Rothman	Not Another Emergency: Assessing and Treating Dental Emergencies in Children	9 a.m. - 12 p.m.
Sa361	GWCC/A404	Dr. Nader Sharifi	Restoring Endodontically Treated Teeth	9 a.m. - 12 p.m.
Sa362	GWCC/A402	Laci Phillips Newland Minal Sampat	Ready Set Interact: Hands On Leadership, Marketing & Team Building!	9:30 - 11:30 a.m.
Sa363	GWCC/A311	Lois Banta	High-Impact Communication	9:30 a.m. - 12 p.m.
Sa364	 GWCC	Lisa Mallonee	Life-Saving PPE Essentials: Diet, Exercise, Self Care	10 - 11:30 a.m.
Sa365	 GWCC	Dr. Wayne Kerr	When Life Needs a Sticky Note	12 - 1:30 p.m.
Sa366	GWCC/A411	Laci Phillips Newland	Constantly Plugged In and Desperately Seeking Balance	1 - 2:30 p.m.
Sa367	GWCC/A313		Pre-Dental Society	10 a.m. - 12 p.m.

\*REPEATED COURSE | Note: Course list is subject to change.

Receptions & Gatherings listed on page 16.



## THE HINMAN SHOP

Take Hinman home with you! Stop by the Hinman Shop, located near registration in the GWCC Building A main entrance.

A variety of items are for sale, including t-shirts, water bottles, tote bags, baby onesies, teddy bears....and more!! Proceeds from the store will be used by the Hinman Trustees for scholarships to support the future of dentistry.

# Receptions & Gatherings

## ALUMNI RECEPTIONS

### Dental College of Georgia

Event Fr450

Friday, March 17

5 – 7 p.m.

Hudson Grille, 120 Marietta Street NW

Wes Zamzow | wzamzow@augusta.edu | 706-721-2699

### University of Kentucky College of Dentistry

Event Fr452

Friday, March 17

5:30 – 7 p.m.

Omni Hotel at CNN Center, International Ballroom D

Ryan Vicini | rlvici2@uky.edu | 859-323-6676

### Emory Dental Alumni Association

Event Fr457

Friday, March 17

5:30 – 7 p.m.

Omni Hotel, International Ballroom AB

Ruthy Cunningham | ruth.cunningham@emory.edu |

404-825-6348

### University of Louisville School of Dentistry

Event Fr455

Friday, March 17

5:30 – 7 p.m.

Omni Hotel at CNN Center, International Ballroom C

Fran Williams | fran.williams@louisville.edu | 502-852-5077

### Georgia Dental Society

Event Fr454

Friday, March 17

5 – 7 p.m.

Margaritaville at Centennial Park

155 Centennial Olympic Park Drive, Atlanta 30303

Dr. Darryal McCullough | drmccullough5010@gmail.com |

404-314-9488

### University of North Carolina School of Dentistry

Event Fr458

Friday, March 17

5:30 – 7 p.m.

Omni Hotel at CNN Center, Grand Ballroom D2E

Kaylee Cutler | kayleec@unc.edu | 919-537-3895

### University of Tennessee College of Dentistry

Event Fr451

Friday, March 17

5 – 7 p.m.

Omni Hotel at CNN Center, International Ballroom E

Terri Catafygiotu | tcatafyg@uthsc.edu | 901-448-8580

### Meharry Medical College

Event Sa459

Saturday, March 18

5 – 7:30 p.m.

Omni Hotel, International Ballroom A

Michelle Viera | mviera@mmc.edu | 615-566-3729

### Virginia Commonwealth University School of Dentistry

Event Fr456

Friday, March 17

5:30 – 7 p.m.

Omni Hotel at CNN Center, International Ballroom F

Gloria Callihan | gfcallihan@vcu.edu | 804-828-8101

### University of Alabama School of Dentistry

Event Fr453

Friday, March 17

5 – 6:30 p.m.

Omni Hotel at CNN Center, Pecan Foyer

Abby Vinson | abbyv@uab.edu | 205-934-3575



# History of the THOMAS P. HINMAN DENTAL MEETING

The Thomas P. Hinman Dental Meeting is sponsored by the Hinman Dental Society, a non-

profit organization. The first Meeting was held in Dr. Thomas P. Hinman and was considered to be the first clinic strictly for serious-minded educational purposes. The Meeting developed a reputation for devotion to detail and hospitality that continues to grow through the years with every meeting.

Born in 1870, Thomas Hinman graduated from Southern Dental College in Atlanta with his Doctor of Dental Surgery degree in 1891.

The first classes for the Atlanta Midwinter Clinic, later renamed the Thomas P. Hinman Dental Meeting, were initially limited to 40 dentists with strict focus on education. The attendee was honor-bound to return to his state dental society and present what he had learned in a formal program.

Today, the focus is still on providing the best possible education, not only for dentists, but also for the entire dental team. The program addresses the needs of general dentists, specialists, hygienists, assistants, office staff, lab techs and students.

The Hinman Dental Society today is comprised of 830 dentist members, primarily located in metropolitan Atlanta. The membership responsibilities include service during the Meeting each year.

The excess revenue of the Meeting is invested and gifted in the form of scholarships to individuals and in contributions to institutions that foster dental education whether at the undergraduate or post-graduate level. The Society has provided more than \$10 million in total giving.

## Name Badge Updates

Your ticket summary does not contain the room locations. The locations are available at [Hinman.org](http://Hinman.org), on the APP or in this publication.

### QR CODE:

This code contains your contact information. Exhibitors will scan this barcode when you visit their booths.

We'll send you an email after the Meeting with a list of all the booths you visited!

### BADGE NUMBER:

You will need this number to access your registration account, redeem CE and to log into the Hinman APP.

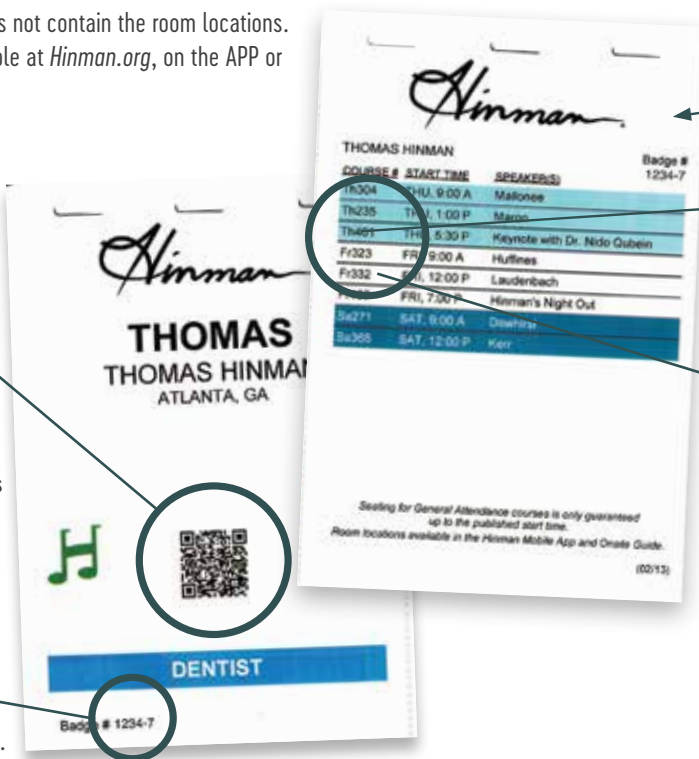

This is your ticket summary

### EVENT ID:

- Th for Thursday
- Fr for Friday
- Sa for Saturday

The number tells you about the type of course:

- 100 (participation course)
- 200 (registered attendance lecture and interactive course)
- 300 (general attendance lecture)
- 400 (special event)

# Thank you to our Hinman Dental Meeting Committee Chairs!

Dr. Roy A. McDonald, General Chair & Dr. E. David Anderson, President

## Advisory

Kate Robinson

## Arrangements

Evis Babo  
Lauren Bowersox

## Clinic Captains

Melissa Durand  
Matt Mazzawi  
Kristina Dawson

## Closing Session

Steve Rafeedie

## Continuing Education

Shiven Gandhi

## Finance

Jane Puskas

## Hinman Information

Jeremy Ward  
David Marion  
Victor van Greuningen

## Hinman's Night Out

Michael Long  
Sherry Jordan  
Lindsay Pope

## Hospitality

Billy & Lynn Callahan  
Tom & Becky Callahan  
Slade & Kristy Lail  
Pat & Julie Yancey

## Host

William Rousseau

## Keynote Session

Jane Puskas

## Participation

Lauren Freitag  
Andy Ramsey  
Rod Carter  
Brett Schroeder  
Travis Watson

## Pre-Keynote

Darryal McCullough

## Program

Brad Greenway  
Troy Schulman

## Publications

Darryal McCullough  
Cristi Cheek

## Public Relations

Brook Corbett

## Registration

Ben Hawkins  
Dan Hodges

## Reserve

Jim Granade III

## Signs

Sherry Jordan  
Janine Bethea

## Special Events

Debbie McDonald  
Susan Anderson

## Table Clinics

Steve Rafeedie

## Technical Exhibits

Jane Puskas  
Roy McDonald

## Transportation

Henry Benson  
Ken Berger

## Treasurer

Troy Schulman

## Accreditation & Continuing Education Credit

The Thomas P. Hinman Dental Meeting has carefully selected all lecturers, exhibits and exhibitors to present at the 2023 Hinman Dental Meeting. The contents of any particular program, lecture, exhibit or handout are the responsibility of the respective lecturer or exhibitor presenting such material. The Hinman Dental Society does not endorse or approve any materials so presented.

The Hinman Dental Meeting utilizes a computerized accreditation process. Hinman provides one hour of credit for each hour of lecture, unless indicated under the course description. Use your name badge and four-digit completion code to process your CE credit while onsite.

Continuing education credits can be processed and certificates printed during the Meeting:

### 1) Exhibit Hall CE Printing Station

(located by Eatery #1)

Thursday: 9:30 a.m. – 5 p.m.

Friday: 9:30 a.m. – 6 p.m.

Saturday: 9:30 a.m. – 3 p.m.

### 2) Registration Hall

Saturday: 1 – 5:30 p.m.



The Thomas P. Hinman Dental Meeting  
Nationally Approved PACE Program  
Provider for FAGD/MAGD credit.  
Approval does not imply acceptance by  
any regulatory authority or AGD endorsement.  
6/1/2021 to 5/31/23  
Provider ID# 219082

AGD members should process their CE no later than  
Monday, April 17, 2023 for the Hinman 2023 meeting.

## Audio, Photo & Video Disclaimer

Photographs, audio recordings and videos may be taken during the meeting by Hinman and approved media representatives and contractors. When registering for the meeting, exhibitors and attendees grant Hinman, its subsidiaries and affiliated entities, approved media and their respective employees and agents, the irrevocable right and permission to use any such photograph, audio recording and video taken during the meeting, for purposes of news reporting, promotion and advertising and trade in any medium or context now known or later developed, without further authorization.

## Handouts

Course handouts are available through April 11, 2023 for those courses where a speaker provides a handout. View handouts in the Hinman APP or by logging into your registration account.

## Mothers Room

Look for the Mamava Nursing Pod in the GWCC, B Building, 300 level (past Hinman Registration as you head into the B Building). There you will find a private space for nursing mothers.

## Dining Options

Go to pages 23-25 in this guide for dining options in the GWCC and Omni Hotel. There are two Hinman Eateries located in the Exhibit Hall. Hours are listed on page 26 and food vendors are listed on the Exhibit Hall floorplan, pages 28-29.

## Onsite Registration

GWCC, A Building, Main Entrance

Hours:

Wednesday: 1 – 5 p.m.

Thursday: 7:30 a.m. – 5 p.m.

Friday: 7:30 a.m. – 5 p.m.

Saturday: 7:30 a.m. – 4 p.m.

## Coat & Luggage Check

Coat & luggage check is available at Hinman Onsite Registration for \$5 per item (credit card only) during the above hours (Thursday through Saturday only).



# Hinman®

The Gateway to Systemic Health:

IT STARTS WITH A *Smile*



March 21-23, 2024  
111th Thomas P. Hinman Dental Meeting

Georgia World Congress Center & Omni Hotel at CNN Center  
Dr. J. Sedgie Newsom, General Chair & Dr. Troy H. Schulman, President



# 2024 HOTEL RATES

HOTEL	STARTING RATE
AC Hotel Atlanta Downtown . . . . .	\$240
Aloft Atlanta Downtown . . . . .	\$229
Atlanta Marriott Marquis . . . . .	\$229
Courtyard Atlanta Downtown . . . . .	\$220
Embassy Suites Atlanta at Centennial Park . . . . .	\$254
Glenn Hotel . . . . .	\$249
Hilton Garden Inn Atlanta Downtown . . . . .	\$246
Holiday Inn Express . . . . .	\$195
Hyatt Place Centennial Park . . . . .	\$239
Hilton Downtown . . . . .	\$187
Omni Hotel at CNN Center . . . . .	\$232
Signia Atlanta . . . . .	\$249
Springhill Suites Atlanta Downtown . . . . .	\$215
The American, a Doubletree by Hilton Atlanta Downtown . . . . .	\$223
Ritz-Carlton, Atlanta . . . . .	\$260
Westin Peachtree Plaza . . . . .	\$226

Stop by the housing desk to **book your 2024 Hinman hotel room** and snag a reusable water bottle! Refill your water bottle at the housing desk throughout the meeting.



Book your 2024 Hinman Hotel and **enter to win** one of these great prizes:

## Book on Thursday, March 16

and be entered for a chance to win:

- One (1) complimentary three (3) night stay at Hinman 2024.
- One (1) complimentary three (3) night stay at any Marriott property in the Continental U.S.
- One (1) complimentary five (5) night stay at any Marriott property in the Continental U.S.

## Book on Friday, March 17

and be entered for a chance to win one (1) complimentary three (3) night stay at Hinman 2024.

## Book on Saturday, March 18

and be entered for a chance to win one (1) complimentary three (3) night stay at Hinman 2024.

**New Location!** The housing desk has moved and is now just outside the Sidney Marcus Auditorium (GWCC, 400 level).

# 2024 SPEAKERS\*

Dr. Alan Atlas . . . . . Cosmetics & Restorative  
 Dr. Josh Austin . . . . . Materials  
 Dr. Courtney Brady . . . . . TMJ  
 Dr. Jeff Brucia . . . . . Restorative Dentistry  
 Dr. Dan Butterman . . . . . CAD/CAM & Implant Restoration  
 Dr. Ellie Campbell . . . . . Oral Systemic Health  
 Dr. Justin Chi . . . . . Digital Dentistry  
 Dr. Gordon Christensen . . . . . Prosthodontics  
 Dr. David Clark . . . . . Composites  
 Dr. Hal Crossley . . . . . Pharmaceuticals  
 Dr. Dan Coleman . . . . . Periodontics  
 Dr. Todd Davis . . . . . Occlusal Equilibration  
 Dr. Chad Duplantis . . . . . 3D Cone Beam  
 Dr. Bruce Edelstein . . . . . Photography  
 Dr. Robert Edwab . . . . . Oral Surgery  
 Dr. Erin Elliott . . . . . Sleep Medicine & Airway  
 Dr. Dennis Fasbinder . . . . . CAD/CAM Materials  
 Dr. Brooke Fukuoka . . . . . Silver Diamine

Dr. Mitchell Gardiner . . . . . Legal  
 Dr. Mia Geisinger . . . . . Periodontics  
 Dr. Howard Glazer . . . . . Materials  
 Dr. Manor Haas . . . . . Endodontics  
 Dr. Van Haywood . . . . . Bleaching  
 Dr. Kevin Henry . . . . . Assisting  
 Amanda Hill . . . . . Infection Control  
 Lora Hooper . . . . . Biologic Testing  
 Dr. Mark Hyman . . . . . Motivation  
 Dr. Meetu Kohli . . . . . Endodontics  
 Dr. Paul Levi . . . . . Periodontics  
 Charles Loretto . . . . . Business  
 Dr. Tieraona Low Dog . . . . . Oral Systemic Health  
 Dr. Stanley Malamed . . . . . Anesthesia  
 Dr. Susan Maples . . . . . Oral Systemic Health  
 Judy Kay Mausolf . . . . . Leadership  
 Dr. Tom McDonald . . . . . Complex Restorations  
 Dr. Gigi Meinecke . . . . . Botox  
 Dr. George Merijohn . . . . . Periodontics  
 Dr. Susan Muller . . . . . Pathology

Dr. Jonathan Ng . . . . . Digital Dentistry  
 Dr. Uche Odiatu . . . . . Nutrition  
 Dr. Jeff Pafford . . . . . Endodontics  
 Laci Phillips Newland . . . . . Communication  
 Dr. Mike Pruett . . . . . Implant Dentistry  
 Dr. David Rice . . . . . Smile Design  
 Amber Riley . . . . . Forensics  
 Dr. David Rothman . . . . . Pediatric Dentistry  
 Katrina Sanders . . . . . Oral Inflammation  
 Dr. Todd Schoenbaum . . . . . Implant Dentistry  
 Dr. Rico Short . . . . . Endodontics  
 Dr. Lee Silverstein . . . . . Suturing & Crown Lengthening  
 Dr. Arjun Srinivasan . . . . . Antibiotics  
 Dr. John Svrisky . . . . . Pathology  
 Dr. Lori Trost . . . . . Digital Dentistry  
 Olivia Wann . . . . . OSHA and HIPPA  
 Carrie Webber . . . . . Practice Management  
 Dr. DeWitt Wilkerson . . . . . Oral Systemic Health  
 Dr. Juan Yepes . . . . . Pediatric Dentistry

\*Visit [Hinman.org](http://Hinman.org) on June 1 to see complete list of speakers.



# Shuttle Schedule

Every 10-15 Minutes {  
 Thursday: 7 a.m. – 8 p.m.  
 Friday:\* 7 a.m. – 7 p.m.  
 Saturday: 7 a.m. – 5:30 p.m.

## Route 1

Westin Peachtree Plaza	Spring Street Motor Lobby
Holiday Inn Downtown Express & Suites	Board at Westin
The American, a Doubletree by Hilton	Board at Westin
AC Hotel Downtown	Board at Westin

## Route 2

Springhill Suites	Board on Ivan Allen
Hilton Garden Inn Downtown	In front of hotel – Baker Street
Hyatt Place Atlanta Downtown	Board at Springhill Suites

## Route 3

Aloft	Board on Baker Street
Atlanta Marriot Marquis	Board on Baker Street
Hilton Atlanta	Board on Baker Street
Hyatt Regency Atlanta	Board on Baker Street

## Route 4

Ritz-Carlton, Atlanta	Board on Ellis Street
Courtyard Atlanta Downtown	Board at Ritz
Sheraton Atlanta	Board on International Street

*\*Shuttle service runs from the above hotels (and the Omni) to the Tabernacle, to service the Hinman’s Night Out party, from 6:45 – 11 p.m.*



## Thank You for Supporting a Dental Meeting that Supports the Dental Community.

The Meeting is sponsored by the Hinman Dental Society, a non-profit organization, and all excess revenue is invested and then gifted in the form of scholarships to individuals and institutions that foster dental education.

The society has provided more than \$10 million in total giving to date.



# GEORGIA WORLD CONGRESS CENTER

BUILDING A | LEVEL 4 CONOURSE  
MEETING ROOMS A402 – A412

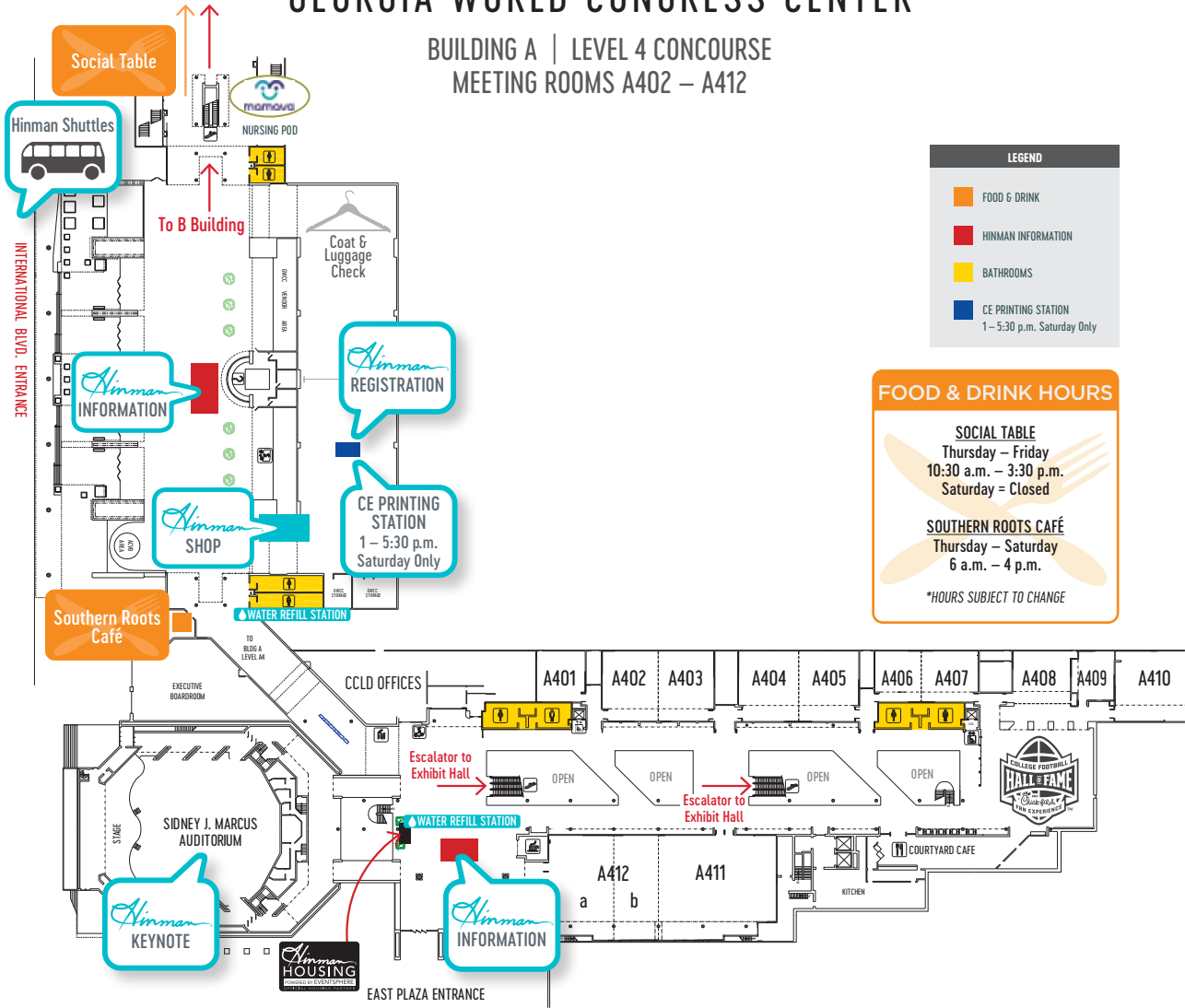

LEGEND	
[Orange Box]	FOOD & DRINK
[Red Box]	HINMAN INFORMATION
[Yellow Box]	BATHROOMS
[Blue Box]	CE PRINTING STATION 1 – 5:30 p.m. Saturday Only

**FOOD & DRINK HOURS**

**SOCIAL TABLE**  
Thursday – Friday  
10:30 a.m. – 3:30 p.m.  
Saturday = Closed

**SOUTHERN ROOTS CAFÉ**  
Thursday – Saturday  
6 a.m. – 4 p.m.

*\*HOURS SUBJECT TO CHANGE*

BUILDING A | LEVEL 3 CONOURSE  
MEETING ROOMS A301 – A316



OMNI ATLANTA HOTEL AT CNN CENTER  
**SOUTH TOWER**

**ATRIUM TERRACE LEVEL (AT)**

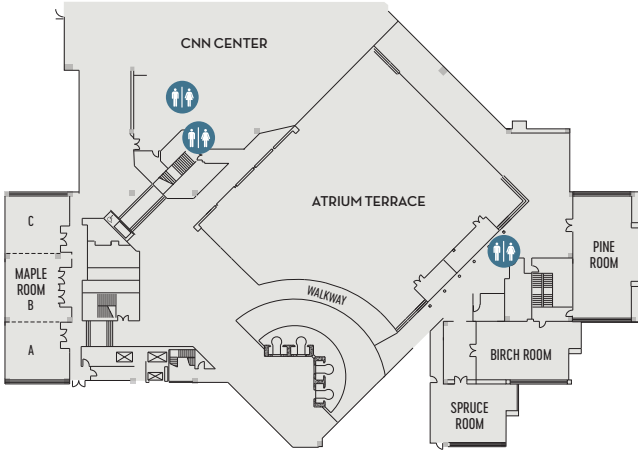

**HOTEL LOBBY LEVEL**

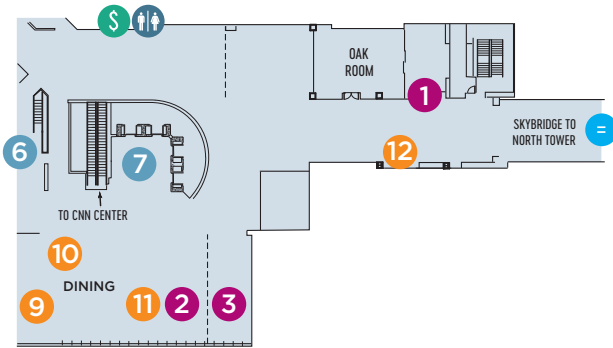

**MOTOR LOBBY LEVEL (ML) & ACCESS TO CNN ATRIUM**

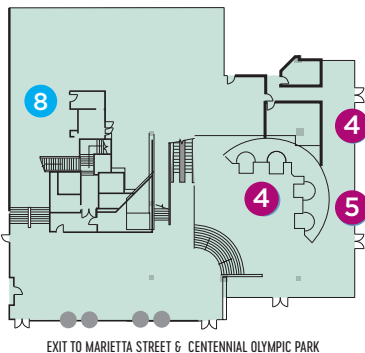

**SERVICES**

- 1 FedEx Office Business Center
- 2 Gift Shop
- 3 Front Desk
- 4 Valet
- 5 Bell Service

**ELEVATORS**

- 6 ADA Elevator
- 7 Guest Room Elevators (Hotel Lobby, Motor Lobby)

**LANDMARKS**

- = Skybridge
- 8 Walkway to CNN Food Court, State Farm Arena & Public Transportation

**FOOD & DRINK**

- 9 New South Kitchen
- 10 Vues Lobby Bar
- 11 Centennial Grounds
- 12 Top Draft

\$ ATM

 RESTROOMS

**FOOD & DRINK HOURS**

**NEW SOUTH KITCHEN**  
 Wednesday – Thursday  
 6:30 – 11 a.m.  
 5:30 – 9:30 p.m.

Friday – Saturday  
 6:30 – 11 a.m.

**VUES (BAR SERVICE ONLY)**  
 Wednesday – Saturday  
 4 – 11 p.m.

**CENTENNIAL GROUNDS**  
 Wednesday – Saturday  
 6:30 a.m. – 11 p.m.

**TOP DRAFT**  
 Wednesday – Saturday  
 11:30 a.m. – 11 p.m.

\*HOURS SUBJECT TO CHANGE

# OMNI ATLANTA HOTEL AT CNN CENTER NORTH TOWER

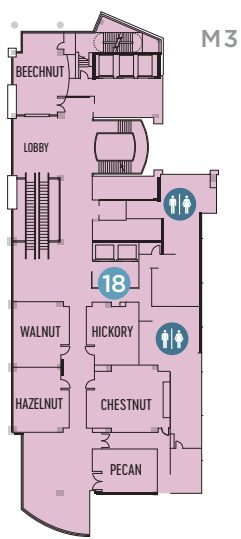
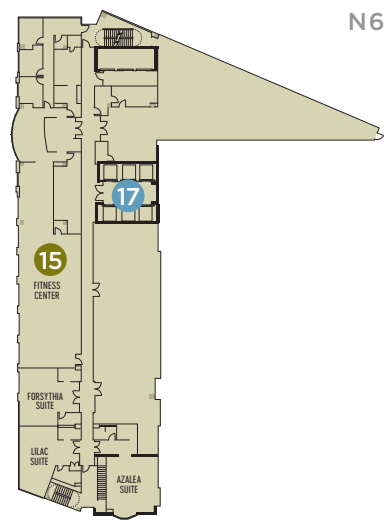
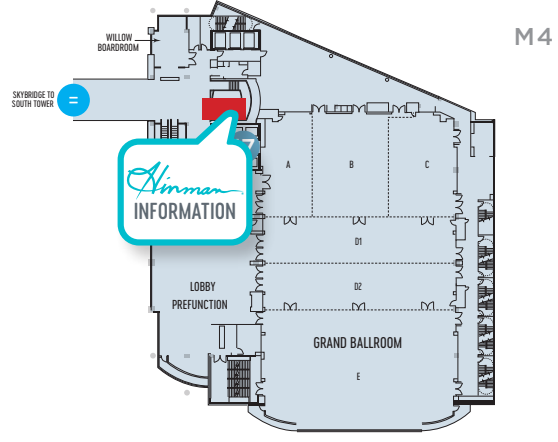
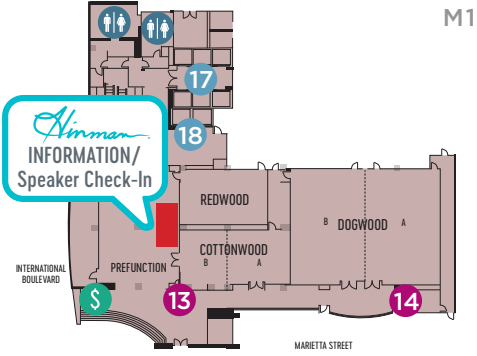

- SERVICES**
- 13** Bell Services
- 14** Valet
- RECREATION & ACTIVITIES**
- 15** 24-Hour Fitness Center
- ELEVATORS**
- 17** Guest Room Elevators (M1, M4, N6 - 28)
- 18** Meeting Room Elevators (M1 - M4)
- LANDMARKS**
- =** Skybridge
- 19** Walkway to Georgia World Congress Center & College Football Hall of Fame
- RECREATION & ACTIVITIES**
- 15** 24-Hour Fitness Center
- FOOD & DRINK**
- 20** Grab 'N' Go Food
- RESTROOMS**
- ATM**

# EXHIBIT HALL

## happenings

### EXHIBIT HALL HOURS

#### Thursday, March 16

9:30 a.m. . . . . Hall Opens  
 10 a.m. – 1 p.m. . . . . Table Clinics  
 11 a.m. – 3 p.m. . . . . Eatery Hours  
 2 – 5 p.m. . . . . Table Clinics  
 3 – 5 p.m. . . . . Exhibit Only Hours  
 5 p.m. . . . . Hall Closes

#### Friday, March 17

9:30 a.m. . . . . Hall Opens  
 11 a.m. – 3 p.m. . . . . Eatery Hours  
 10:30 a.m. – 1:30 p.m. . . . Table Clinics  
 3 – 6 p.m. . . . . Table Clinics  
 5 – 6 p.m. . . . . Exhibit Only Hours  
 6 p.m. . . . . Hall Closes

#### Saturday, March 18

9:30 a.m. . . . . Hall Opens  
 10 a.m. – 2 p.m. . . . . Eatery Hours  
 10 a.m. – 1 p.m. . . . . Table Clinics  
 3 p.m. . . . . Hall Closes

### Social Media Lounge - Booth 2147

**COLTENE** Visit the COLTENE SciCan Social Media Lounge to take a selfie with the life-sized **SciCan** Hinman Signature. Post, hashtag and tweet to show the fun you are having. Don't forget to tag **@HinmanDental** and use the official hashtag **#myhinman** in your posts!

### Podcast Lounge - Booth 749

Bring your device charger and take a break in the podcast lounge. Listen in as popular dental podcasts record their episodes live from Hinman!



*Amber Auger* MPH, RDH  
 AMBERAUGER.COM  
 AMBERAUGERRDH@GMAIL.COM



**Snacks & Happy Hour - Booth 949** (while supplies last)  
 Thursday – Saturday



**Student Drink Tickets - Booth 830** (while supplies last)  
 Thursday and Friday starting at 1:30 p.m.



**Gourmet Coffee Station - Booth 1624**  
 Thursday and Friday 2 – 5 p.m.



**Free Popsicles - Booth 1946** (while supplies last)  
 Thursday and Friday 3 – 5 p.m.



### Table Clinics - Booth 1952

Earn free CE at these scientific table-top presentations that are each approximately 10 minutes in length and given by volunteers in the dental community. Receive a continuing education code for each hour that you spend in the table clinics area.

# Learning Lab Pavilion Schedule

Stop by Booth 500 to hear from our exhibiting partners and earn free CE.



	SPEAKER	COURSE TITLE	TIME
THURSDAY	<b>Mr. Pras Murthy</b> <i>Provided by DDS Multimedia</i>	<b>Th368</b> How To Grow Your Practice (and Your Online Presence)	10 – 11 a.m.
	<b>Mr. Pras Murthy</b> <i>Provided by DDS Multimedia</i>	<b>Th369</b> Marketing Your Practice in the Age of Convenience	11:30 a.m. – 12:30 p.m.
	<b>Dr. Sam Shamardi</b> <i>Provided by Crest + Oral-B</i>	<b>Th370*</b> Impactful Homecare Improvements for Healing and Maintenance Around Implants	1 – 2 p.m.
	<b>Dr. Len Tau</b> <i>Provided by Birdeye</i>	<b>Th371</b> Raving Patients: Get Visible, Get Credible: Get More New Patients	2:30 – 3:30 p.m.
	<b>Dr. Gregori Kurtzman</b> <i>Provided by Nobio Inc./Infinix</i>	<b>Th372</b> Oral Biofilm: The Systemic Effects - How to Manage Clinically & With Homecare	4 – 5 p.m.
FRIDAY	<b>Dr. Sam Shamardi</b> <i>Provided by Crest + Oral-B</i>	<b>Fr373*</b> Impactful Homecare Improvements for Healing and Maintenance Around Implants	10 – 11 a.m.
	<b>Dr. Jose Marciano</b> <i>Provided by Dental Enterprises LLC</i>	<b>Fr374</b> Drill-Free Implantology: Magnetic Dynamic Technology for Minimally-Invasive Procedures	11:30 a.m. – 12:30 p.m.
	<b>Dr. Leonard Tau</b> <i>Provided by Birdeye</i>	<b>Fr376</b> OMG I Got A Bad Review. What Should I Do?	1 – 2 p.m.
	<b>Mr. Ray Berk</b> <i>Provided by Bank of America</i>	<b>Fr377</b> Path to Practice Ownership	2:30 – 3:30 p.m.
	<b>Mr. Brandon Bosch</b> <i>Provided by Dr. Marketing</i>	<b>Fr378</b> Dental Marketing Best Practices	4 – 5 p.m.

# Total Health Pavilion Schedule

Head to Booth 1555 for free CE in the Exhibit Hall each day of the Meeting.



	THURSDAY	FRIDAY	SATURDAY
10 – 11 a.m.		<b>New Product Symposium   Fr379</b>	
10 – 11:30 a.m.	<b>Mr. Ryan Vet   Th306</b> Cracking the Millennial Code: Decoding the Generations to Effectively Motivate and Manage Millennials		<b>Ms. Lisa Mallonee   Sa364</b> Life Saving PPE Essentials: Diet, Exercise, Self Care
12 – 1:30 p.m.	<b>Mr. Gary Salman   Th307*</b> 10 Ways to Build a Ransomware Resilient Practice	<b>Mr. Gary Salman   Fr330*</b> 10 Ways to Build a Ransomware Resilient Practice	<b>Dr. Wayne Kerr   Sa365</b> When Life Needs a Sticky Note
2 – 3:30 p.m.	<b>Dr. Amy Dayries-Ling   Th314</b> An Integrative Approach to Dentistry: Connecting Whole Body Health in the Hygiene Chair	<b>Dr. Larry Williams   Fr346*</b> Tobacco, Vaping and Cannabis: What Do You Know?	

# EXHIBIT HALL *Floor Plan*

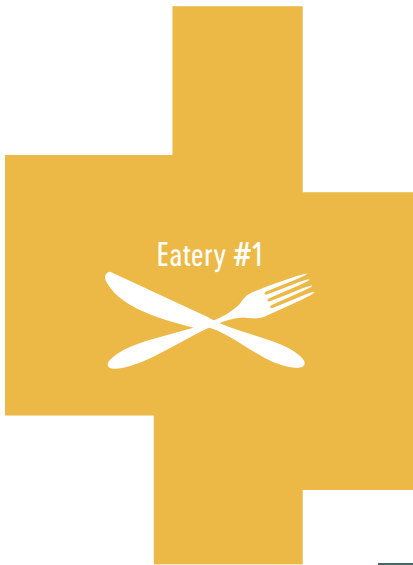

Eaterly #1

**FOOD VENDORS:**  
 Georgia Subs & Salads  
 Baltimore Crab Cakes & Soup  
 Papa Johns Pizza  
 SoKoMe Rice Bowl & Dumplings

**EXHIBITOR SPEAKERS**  
 DDS MultiMedia  
 Crest + Oral B  
 Birdeye  
 Nobio/Infinox  
 Dental Enterprises  
 Bank of America  
 Dr. Marketing



**Coast Dental & Orthodontics**



CE Redemption

**HINMAN MARKETPLACE**  
 Global Fantasy  
 851 751



**SuperMouth**

SuperMouth  
 849

1053 1152  
 1051 1150  
 1049 1148

1153 1252  
 1151 1250  
 1149 1248  
 1147 1246  
 1145 1244  
 1143 1242  
 1141 1240

142  
 140

743 840  
 Digital Technology

845 944  
 843 942  
 841 940  
 Air Techniques

945 1042  
 943 1042  
 941 1040  
 Henry Schein

1043 1140  
 1041 1140  
 Q-optics

COURSE ROOM #2

COURSE ROOM #1

734  
 732  
 730  
 728  
 726  
 724  
 722  
 720

735 834  
 733 832  
 731 830  
 Digital Technology

833 932  
 831 930  
 827 926  
 825 924  
 821 920  
 Walker Dental Inc.  
 Porter Royal Sales

935 1034  
 931  
 927 1026  
 925 1024  
 921 1020  
 NextHealth  
 MacDermid / Prophecy

1035 1134  
 1033 1132  
 1031 1130  
 1025 1124  
 1023 1122  
 1021  
 BISCO

1135 1234  
 1133  
 1131  
 1129 1228  
 1127 1226  
 HUSSEIN, Inc.

714  
 710  
 706  
 704  
 Coast Dental & Orthodontics  
 BioBaa Products  
 Listerine

717 816  
 715 814  
 713 812  
 705  
 Weave

815 904  
 813  
 811  
 807 906  
 805 904  
 Sunbit  
 Straumann Group  
 USA Dental Partners

917 1016  
 915 1014  
 913 1012  
 911 1010  
 905 1004  
 903 1002  
 901 1000  
 1007 1104  
 1005 1104  
 Sun Optics  
 Braxeler USA  
 Savin Dental

1017 1112  
 1015 1112  
 1013 1112  
 1011 1112  
 1009 1108  
 1007 1104  
 1005 1104

1121  
 Water Pik Inc.  
 1115  
 Designs for Vision, Inc.  
 1107  
 Midmark Corporation

100 800 802 801

1000 1002 1001 1100 1101



# EXHIBIT HALL HOURS:

Thursday: 9:30 a.m. – 5 p.m.

Friday: 9:30 a.m. – 6 p.m.

Saturday: 9:30 a.m. – 3 p.m.

Scan to see show specials  
exclusive for  
Hinman attendees!



**NEW PRODUCT SYMPOSIUM**  
Crest + Oral B  
NexHealth  
Beaverstate Dental  
Advanced Materials Engineering Inc.  
WalMart Health



1253	1352
1251	1350
1249	Zyris
1247	1346
1245	1344
1243	1342
1241	RGP, Inc.

1353	1452
1351	1450
1349	1448
1347	1446
1345	1444
1343	1442
1341	Professional

1453	
1451	1550
1449	1548
1447	1546
1445	1544
1443	1542
1441	Bank of America Sunrise Dental

1551	1650
1549	1648
1547	1646
1545	1644
1543	Affinity Bank
1541	1640

1651	1750
1649	1748
1647	1746
1645	1744
1643	1742
1641	Benco Dental

1751	1850
1749	1848
1747	1846
1745	1844
1743	1842
1741	1840



1849	Tempmee
1847	1946
1845	1944
1843	1942
1841	1940

1949	2048
1947	2046
1945	2044
1943	2042
1941	2040

2049	2148
2047	2146
2045	2144
2043	2142
2041	Kerr Dental



1235	1334
1233	1332
1231	Blockstar Matrix
1229	1328
1227	1326
1225	1324
1223	1322
1221	3M



1331	A-dec
1329	1428
1327	1426
1325	1424
1323	1422
1321	Ivoclar

1534	
1531	Nashville Dental, Inc.
1529	Top Quality Manufacturing
1527	1526
1525	1524
1523	1522
1521	1520



1634	
1631	Canstream Dental
1629	1628
1627	1626
1625	1624
1623	1622
1621	1620

1635	SurgiTel
1633	1632
1631	1630
1629	1628
1627	1626
1625	1624
1623	1622
1621	1620

1735	Surgitech
1733	1732
1731	1730
1729	CareCredit - Synchrony
1727	1726
1725	1724
1723	1722
1721	1720

1835	BURST
1833	1932
1831	1930
1829	1828
1827	1826
1825	1824
1823	1822
1821	1820

1935	2034
1933	2032
1931	2030
1929	2028
1927	2026
1925	2024
1923	2022
1921	2020

2035
2033
2031
2029
2027
2025
2023
2021

1211	Atlanta Dental Supply
------	--------------------------



ENTRANCE

1315	PLANMECA USA, Inc.
------	-----------------------

1417	1516
1415	1514
1413	1512
1411	Crest + Oral-B

1517	Preventech
1515	1514
1513	1512
1511	Ritter Dental USA

1613	1716
1611	1712
1609	1708
1607	1706
1605	1704
1603	1702
1601	1700

1717	1816
1715	1814
1713	1812
1711	1810

1817	1916
1815	1914
1813	1912
1811	1910
1809	1908
1807	1906
1805	1904

1917	2016
1915	2014
1913	2012
1911	2010
1909	2008
1907	2006
1905	2004



**FOOD VENDORS:**  
Green Wraps Sandwiches & Salads  
Nathan's Hotdogs  
4 Rivers BBQ  
Papa Johns Pizza  
SoKoMe Rice Bowl



1601	LumaDent	1702	Dental Equipment
------	----------	------	------------------

1900	1901	1902	2002	2001	2003
------	------	------	------	------	------



# EXHIBITORS

## by Product Category

### ABRASIVES, ABRASIVE DISKS, POINTS & WHEELS

Komet . . . . .	1240
Shofu Dental Corporation . . . . .	1324

### AIR ABRASION

Bioclear Matrix Systems . . . . .	1229
LabStore . . . . .	1211
Medidenta / Prophy Magic . . . . .	1020

### AIR COMPRESSORS

ADS Dental System Inc. . . . .	1031
Air Techniques, Inc. . . . .	940
Aseptico. . . . .	1421
Dansereau Health Product . . . . .	904
Dental Equipment Liquidators, Inc. . . . .	1702
DENTALEZ . . . . .	1341
Nashville Dental Inc. . . . .	1431
Professional Sales Associates, Inc. . . . .	1341
Ritter Dental USA . . . . .	1511
Sunrise Dental Equipment, Inc. . . . .	1540

### ALLOYS

The Argen Corporation . . . . .	1646
---------------------------------	------

### AMALGAMATORS

DENTALEZ . . . . .	1341
--------------------	------

### ANALGESIA EQUIPMENT & SUPPLIES

Porter Royal Sales . . . . .	920
Professional Sales Associates, Inc. . . . .	1341

### ANATOMICAL MODELS

Kilgore International, Inc. . . . .	1534
-------------------------------------	------

### ANESTHESIA EQUIPMENT

Onpharma Company . . . . .	1448
----------------------------	------

### ANESTHETICS, LOCAL & ACCESSORIES

Aseptico. . . . .	1421
DentalVibe / Bing Innovation . . . . .	2012
Onpharma Company . . . . .	1448

### ANTIBACTERIAL SOAPS & DETERGENTS

FiteBac Dental. . . . .	802
-------------------------	-----

### APEX LOCATORS

J. Morita USA . . . . .	1034
Vector Research & Development . . . . .	1100

### ARTICULATORS & ACCESSORIES

Bausch Articulating Papers . . . . .	1425
LabStore . . . . .	1211
Panadent . . . . .	1133
Whip Mix Corporation . . . . .	713

### ATTACHMENTS

Dental Office Support . . . . .	717
---------------------------------	-----

### AUTOCLAVES

Atlanta Dental Supply . . . . .	1211
Benco Dental . . . . .	1641
Coltene / SciCan . . . . .	2131
Dental Equipment Liquidators, Inc. . . . .	1702
Midmark Corporation. . . . .	1107
Nashville Dental Inc. . . . .	1431
Professional Sales Associates, Inc. . . . .	1341
Sunrise Dental Equipment, Inc. . . . .	1540
Tuttnauer USA Co., Ltd. . . . .	1341

### BLEACHING PRODUCTS/TEETH WHITENING

Burst . . . . .	1833
Colgate . . . . .	805
Crest + Oral-B. . . . .	1411
DentLight Inc. . . . .	1100
Philips Sonicare and Zoom Whitening . . . . .	1905
Premier Dental Products Company . . . . .	1122
ProBiora Health . . . . .	1914
Top Quality Manufacturing . . . . .	1528
Ultradent Products, Inc. . . . .	1621

### BONDING AGENTS

Bisco . . . . .	1021
GC America Inc. . . . .	1521
Pulpdent Corporation . . . . .	1507
Tokuyama America . . . . .	822
Top Quality Manufacturing . . . . .	1528
Ultradent Products, Inc. . . . .	1621
VOCO America, Inc. . . . .	905

### BONE GRAFTING MATERIALS, SYNTHETIC & IMPLANTS

Augma Biomaterials USA. . . . .	811
Ditron Dental USA . . . . .	2031
Impladent Ltd.. . . . .	1332
J. Morita USA . . . . .	1034
Power Dental Group . . . . .	935
Salvin Dental . . . . .	1104

### BOOKS & PUBLICATIONS PROFESSIONAL/ SCIENTIFIC

Academy of General Dentistry . . . . .	700
Georgia Dental Hygienists' Association . . . . .	730

### BURS, ALL TYPES

Brasseler USA . . . . .	1112
EdgeDental Specialties . . . . .	1805
Golden Dent . . . . .	1135
Impladent Ltd.. . . . .	1332
Kerr Dental . . . . .	2041
Komet. . . . .	1240
Microcopy . . . . .	1825
Premier Dental Products Company . . . . .	1122
Shofu Dental Corporation . . . . .	1324
SS White Dental . . . . .	1417
Top Quality Manufacturing . . . . .	1528

### BUSINESS EQUIPMENT AND/OR OFFICE SUPPLIES

Wassaw Sound . . . . .	735
------------------------	-----

### BUSINESS SERVICES

Adit . . . . .	1349
Advantage Technologies. . . . .	1940
Affinity Bank . . . . .	1640
Bank of America Practice Solutions . . . . .	1441
CARR / Dental Real Estate. . . . .	1147
Choice Transitions, LLC . . . . .	720
Clipper Magazine . . . . .	1344
Crown Tenant Advisors. . . . .	1134
DDS Match South LLC . . . . .	1841
Dental Office Support . . . . .	717
eAssist Dental Solutions. . . . .	1131
Firegang Dental Marketing . . . . .	2040
Heartland Dental . . . . .	1721
Kleer . . . . .	813
McLerran & Associates. . . . .	734
Momnt . . . . .	1016
NexHealth . . . . .	931
PPM - Professional Practice Management . . . . .	1211
Practice by Numbers. . . . .	1906
PracticeLife . . . . .	1211
Scratch Financial, Inc . . . . .	733
Star Dental Partners . . . . .	1010
UpSwell Marketing. . . . .	2030
Wassaw Sound . . . . .	735
Weave. . . . .	705



## CABINETS

A-dec . . . . .	1331
ADS Dental System Inc. . . . .	1031
DCI Edge . . . . .	1821
Dental Equipment Liquidators, Inc. . . . .	1702
Midmark Corporation. . . . .	1107
Planmeca USA, Inc. . . . .	1315
Professional Sales Associates, Inc. . . . .	1341
Sunrise Dental Equipment, Inc. . . . .	1540

## CAD/CAM EQUIPMENT

Align Technology . . . . .	1705
Atlanta Dental Supply . . . . .	1211
Benco Dental . . . . .	1641
Biolase Technology, Inc. . . . .	1325
Dandy . . . . .	1624
Dental Science Lab . . . . .	1243
Dentsply Sirona . . . . .	2002
Glidewell Dental. . . . .	1017
Hahn Implants. . . . .	1007
Henry Schein Dental. . . . .	1042
Ivoclar . . . . .	1321
LabStore . . . . .	1211
Patterson Dental Supply, Inc. . . . .	1622
Planmeca USA, Inc. . . . .	1315
Video Dental Concepts. . . . .	1604
Whip Mix Corporation . . . . .	713

## CAMERAS

Atlanta Dental Supply . . . . .	1211
Atlantic Dental Solutions . . . . .	1100
Benco Dental . . . . .	1641
Carestream Dental. . . . .	1529
DentLight Inc. . . . .	1100
Designs for Vision, Inc. . . . .	1115
Digital Doc, LLC . . . . .	1000
Shofu Dental Corporation . . . . .	1324
SurgiTel . . . . .	1635
Video Dental Concepts. . . . .	1604

## CASTING MACHINE & ALLOYS

The Argen Corporation . . . . .	1646
---------------------------------	------

## CAVITY PREP SYSTEMS

FiteBac Dental. . . . .	802
SS White Dental. . . . .	1417

## CEMENTS, ALL TYPES

3M . . . . .	1221
Bisco . . . . .	1021
GC America Inc. . . . .	1521
Ivoclar . . . . .	1321
Kettenbach . . . . .	921
Premier Dental Products Company . . . . .	1122

Pulpdent Corporation . . . . .	1507
Shofu Dental Corporation . . . . .	1324
Tokuyama America . . . . .	822
Ultradent Products, Inc. . . . .	1621
VOCO America, Inc. . . . .	905

## CHAIRS & ACCESSORIES

A-dec . . . . .	1331
ADS Dental System Inc. . . . .	1031
Atlanta Dental Supply . . . . .	1211
Beaverstate Dental, Inc. . . . .	1001
BQ Ergonomics . . . . .	1741
Dansereau Health Product . . . . .	904
DCI Edge . . . . .	1821
Dental Equipment Liquidators, Inc. . . . .	1702
DENTALEZ . . . . .	1341
Dentsply Sirona . . . . .	2002
Henry Schein Dental. . . . .	1042
Midmark Corporation. . . . .	1107
Nashville Dental Inc. . . . .	1431
Patterson Dental Supply, Inc. . . . .	1622
PLANMECA USA, Inc. . . . .	1315
Porter Royal Sales. . . . .	920
Professional Sales Associates, Inc. . . . .	1341
RGP, Inc. . . . .	1241
Ritter Dental USA . . . . .	1511
Sunrise Dental Equipment, Inc. . . . .	1540
SurgiTel . . . . .	1635
Wassaw Sound . . . . .	735

## CLAIMS PROCESSING

Dental Office Support . . . . .	717
eAssist Dental Solutions. . . . .	1131
PractiLife . . . . .	1211

## COLLECTION FIRMS

Wassaw Sound . . . . .	735
------------------------	-----

## COMPOSITE RESIN PRODUCTS

3M . . . . .	1221
Bioclear Matrix Systems . . . . .	1229
Bisco . . . . .	1021
Garrison Dental Solution . . . . .	1427
Golden Dent. . . . .	1135
Kettenbach . . . . .	921
Pulpdent Corporation . . . . .	1507
Shofu Dental Corporation . . . . .	1324
Tokuyama America . . . . .	822
Top Quality Manufacturing . . . . .	1528
Ultradent Products, Inc. . . . .	1621
VOCO America, Inc. . . . .	905

## COMPUTERS

Advantage Technologies . . . . .	1940
Digital Technology Partners . . . . .	840
Florida Probe VoiceWorks . . . . .	1715
Lighthouse 360 . . . . .	1516
Patterson Dental Supply, Inc. . . . .	1622
PractiLife . . . . .	1211
RecallMax. . . . .	1233
Sodium Dental. . . . .	827
Vatech America . . . . .	1712

## CONSULTANT

ADS South. . . . .	1326
Advantage Technologies . . . . .	1940
Atlanta Design Associates . . . . .	1211
Choice Transitions, LLC . . . . .	720
Crown Tenant Advisors. . . . .	1134
Dental Office Support . . . . .	717
Digital Technology Partners . . . . .	840
Heartland Dental . . . . .	1721
Lighthouse 360 . . . . .	1516
McGill & Hill Group. . . . .	1520
McLerran & Associates. . . . .	734
PPM - Professional Practice Management . . . . .	1211

## CONTINUING EDUCATION & TRAINING

Academy of General Dentistry . . . . .	700
Academy of Microscope Enhanced Dentistry. . . . .	1743
American Academy for Oral & Systemic Health. . . . .	1915
Bioclear Matrix Systems . . . . .	1229
CR Foundation Gordon J. Christensen Clinicians Report . . . . .	1227
DANB and the DALE Foundation. . . . .	715
Ditron Dental USA . . . . .	2031
Georgia Dental Association . . . . .	843
Georgia Dental Hygienists' Association . . . . .	730
Golden Dent. . . . .	1135
Heartland Dental . . . . .	1721
Hiossen, Inc. . . . .	1228
Lighthouse 360 . . . . .	1516
McGill & Hill Group. . . . .	1520
OSAP, Organization for Safety, Asepsis, and Prevention . . . . .	724
PractiLife . . . . .	1211
SuperMouth. . . . .	949
The Pankey Institute. . . . .	723

## COTTON PRODUCTS

Microcopy. . . . .	1825
--------------------	------

## CROWNS AND/OR CROWN & BRIDGE MATERIALS

3M . . . . .	1221
Common Sense Dental Products . . . . .	1711
Dandy . . . . .	1624
Dental Science Lab . . . . .	1243
Glidewell Dental . . . . .	1017
Golden Dent . . . . .	1135
Hahn Implants . . . . .	1007
Hiossen, Inc. . . . .	1228
Ivoclar . . . . .	1321
Kettenbach . . . . .	921
PDT, Inc. . . . .	1631
The Argen Corporation . . . . .	1646
VOCO America, Inc. . . . .	905

## CURING LIGHTS

Acteon North America . . . . .	1817
Atlantic Dental Solutions . . . . .	1100
CAO Group . . . . .	1910
DentLight Inc. . . . .	1100
Ivoclar . . . . .	1321
Ultradent Products, Inc. . . . .	1621
Vector Research & Development . . . . .	1100

## DEFIBRILLATORS

ZOLL Medical Corporation . . . . .	1429
------------------------------------	------

## DELIVERY SYSTEMS PORTABLE

A-dec . . . . .	1331
Aseptic . . . . .	1421
Medidenta / Prophy Magic . . . . .	1020

## DENTAL DEALERS

Benco Dental . . . . .	1641
Choice Transitions, LLC . . . . .	720
Doral Refining Corp. . . . .	1424
Henry Schein Dental . . . . .	1042
Henry Schein Dental Practice Transitions . . . . .	1014
Patterson Dental Supply, Inc. . . . .	1622
Top Quality Manufacturing . . . . .	1528
Video Dental Concepts . . . . .	1604

## DENTAL HYGIENE MATERIALS (not otherwise classified)

Elevate Oral Care . . . . .	1522
GC America Inc. . . . .	1521
Georgia Dental Hygienists' Association . . . . .	730
Medidenta / Prophy Magic . . . . .	1020
Microcopy . . . . .	1825
Preventech . . . . .	1517
ProBiora Health . . . . .	1914
Pulpdent Corporation . . . . .	1507
Rose Micro Solutions . . . . .	1334, 1717
Simply Hygiene . . . . .	1211

## DENTAL LABORATORIES

ClearCorrect . . . . .	906
Dandy . . . . .	1624
Dental Science Lab . . . . .	1243
DENTALEZ . . . . .	1341
Glidewell Dental . . . . .	1017
Hahn Implants . . . . .	1007
LabStore . . . . .	1211
New Image Dental Laboratory . . . . .	1541
Straumann Group . . . . .	906

## DENTAL UNITS

A-dec . . . . .	1331
ADS Dental System Inc. . . . .	1031
Beaverstate Dental, Inc. . . . .	1001
CAO Group . . . . .	1910
Dansereau Health Product . . . . .	904
DCI Edge . . . . .	1821
DENTALEZ . . . . .	1341
Medi Lazer . . . . .	820
Midmark Corporation . . . . .	1107
PLANMECA USA, Inc. . . . .	1315
Sunrise Dental Equipment, Inc. . . . .	1540
Whip Mix Corporation . . . . .	713

## DENTIFRICE

Burst . . . . .	1833
Colgate . . . . .	805
Crest + Oral-B . . . . .	1411
Elevate Oral Care . . . . .	1522
Haleon . . . . .	2016

## DENTURES

Dandy . . . . .	1624
Dental Science Lab . . . . .	1243
Glidewell Dental . . . . .	1017
Hahn Implants . . . . .	1007
Haleon . . . . .	2016
Ivoclar . . . . .	1321
LabStore . . . . .	1211

## DESENSITIZERS

Bisco . . . . .	1021
Elevate Oral Care . . . . .	1522
Haleon . . . . .	2016
Tokuyama America . . . . .	822
VOCO America, Inc. . . . .	905

## DIAGNOSTIC EQUIPMENT

Air Techniques, Inc. . . . .	940
Carestream Dental . . . . .	1529
Direct Diagnostics . . . . .	1917
J. Morita USA . . . . .	1034
Panadent . . . . .	1133

Sodium Dental . . . . .	827
Vatech America . . . . .	1712

## DIETARY PRODUCTS

ProBiora Health . . . . .	1914
---------------------------	------

## DISINFECTING SOLUTIONS, ASEPSIS

CAO Group . . . . .	1910
Coltene / SciCan . . . . .	2131
Zyris, creators of Isolite . . . . .	1346

## DISKS & MANDRELS & STRIPS

Komet . . . . .	1240
-----------------	------

## EDUCATIONAL MATERIALS & VIDEOS (PATIENT & DOCTOR)

Academy of General Dentistry . . . . .	700
American Academy for Oral & Systemic Health . . . . .	1915
Bioclear Matrix Systems . . . . .	1229
ClearCorrect . . . . .	906
CR Foundation Gordon J. Christensen Clinicians Report . . . . .	1227
Curve Dental . . . . .	1025, 1934
Ditron Dental USA . . . . .	2031
Elevate Oral Care . . . . .	1522
Florida Probe VoiceWorks . . . . .	1715
Georgia Dental Hygienists' Association . . . . .	730
Glidewell Dental . . . . .	1017
Gordon J. Christensen - Practical Clinical Courses . . . . .	1225
Greater New York Dental Meeting . . . . .	1130
Hahn Implants . . . . .	1007
Kilgore International, Inc. . . . .	1534
Nadia International, Inc. . . . .	1423
OSAP, Organization for Safety, Asepsis, and Prevention . . . . .	724
Panadent . . . . .	1133
Straumann . . . . .	906

## ELECTROSURGICAL EQUIPMENT

Impladent Ltd. . . . .	1332
------------------------	------

## ENDODONTIC INSTRUMENTS & SUPPLIERS

A. Titan Instruments . . . . .	1035
Brasseler USA . . . . .	1112
CAO Group . . . . .	1910
Common Sense Dental Products . . . . .	1711
Dentsply Sirona . . . . .	2002
EdgeDental Specialties . . . . .	1805
Hu-Friedy Mfg. Co., LLC . . . . .	1716
J. Morita USA . . . . .	1034
Karl Schumacher Dental, LLC . . . . .	1941
Kerr Dental . . . . .	2041

Medidenta / Prophy Magic . . . . .	1020
Pulpdent Corporation . . . . .	1507
SS White Dental . . . . .	1417
Zoll-Dental . . . . .	1606

#### EQUIPMENT LEASING & FINANCING

Atlanta Design Associates . . . . .	1211
Bank of America Practice Solutions . . . . .	1441
Huntington Bank Practice Finance . . . . .	1033
United Community Bank . . . . .	841

#### EQUIPMENT REPAIR & MAINTENANCE

American SensorTech . . . . .	1043
-------------------------------	------

#### EVACUATORS & EVACUATOR SYSTEMS

Air Techniques, Inc. . . . .	940
Zyris, creators of Isolite . . . . .	1346

#### EYEWEAR, PROTECTIVE

DentLight Inc. . . . .	1100
Designs for Vision, Inc. . . . .	1115
LumaDent . . . . .	1601
Q-Optics & Quality Aspirators . . . . .	1140
Rose Micro Solutions . . . . .	1334, 1717
SurgiTel . . . . .	1635

#### FIBER OPTIC ILLUMINATOR PRODUCTS

Designs for Vision, Inc. . . . .	1115
Q-Optics & Quality Aspirators . . . . .	1140

#### FILLING MATERIALS & ACCESSORIES

3M . . . . .	1221
Ivoclar . . . . .	1321

#### FINANCIAL SERVICES

Affinity Bank . . . . .	1640
Bank of America Practice Solutions . . . . .	1441
Cain, Watters & Associates . . . . .	1713
CareCredit - Synchrony . . . . .	1729
Doctors Disability Specialists . . . . .	830, 1816
Equitable - ADA Members Retirement Program	1902
First Citizens Bank . . . . .	740
Four Quadrants Advisory . . . . .	814
Henry Schein Dental Practice Transitions. . . . .	1014
Huntington Bank Practice Finance . . . . .	1033
Kleer . . . . .	813
LendingPoint . . . . .	1943
McGill & Hill Group. . . . .	1520
Momnt . . . . .	1016
PNC Healthcare Business Banking . . . . .	1912
PPM - Professional Practice Management . . . . .	1211
Practice Pathways - Zions Bank . . . . .	728
PracticeLife . . . . .	1211
Provide . . . . .	1628

Scratch Financial, Inc . . . . .	733
United Community Bank . . . . .	841
Wassaw Sound . . . . .	735
Wells Fargo Practice Finance. . . . .	1613

#### FLOSS

Burst . . . . .	1833
Colgate . . . . .	805
Crest + Oral-B. . . . .	1411
Sunstar Americas, Inc.. . . . .	1226
SuperMouth . . . . .	949

#### FLUORIDE PRODUCTS (other than dentifrice)

Bisco . . . . .	1021
Colgate . . . . .	805
Elevate Oral Care . . . . .	1522
Preventech . . . . .	1517
SuperMouth . . . . .	949
VOCO America, Inc. . . . .	905

#### FURNACES

Ivoclar . . . . .	1321
Whip Mix Corporation . . . . .	713

#### GLOVES

Benco Dental . . . . .	1641
Top Quality Manufacturing . . . . .	1528

#### GOLD

Doral Refining Corp. . . . .	1424
Garfield Refining. . . . .	1235

#### HANDPIECES, OPERATING, LABORATORY & ACCESSORIES

A-dec . . . . .	1331
ADS Dental System Inc. . . . .	1031
Aseptico. . . . .	1421
Atlantic Dental Solutions . . . . .	1100
Brasseler USA . . . . .	1112
Coltene / SciCan . . . . .	2131
Dental Enterprises-Magnetic Mallet . . . . .	1330
DENTALEZ . . . . .	1341
Dentsply Sirona . . . . .	2002
J. Morita USA . . . . .	1034
Medidenta / Prophy Magic. . . . .	1020
Nashville Dental Inc. . . . .	1431
NSK America . . . . .	1921
Preventech . . . . .	1517
Prophy Magic . . . . .	1020
The Dentist's Choice. . . . .	1813
Vector Research & Development . . . . .	1100
Zyris, creators of Isolite . . . . .	1346

#### IMPLANTS & ACCESSORIES

Best Instruments . . . . .	1041
Common Sense Dental Products . . . . .	1711
Dandy . . . . .	1624
Dental Science Lab . . . . .	1243
Dentsply Sirona . . . . .	2002
Ditron Dental USA . . . . .	2031
Glidewell Dental. . . . .	1017
Golden Dent. . . . .	1135
Hahn Implants. . . . .	1007
Hiossen, Inc. . . . .	1228
Impladent Ltd.. . . . .	1332
Neodent. . . . .	906
PDT, Inc. . . . .	1631
Power Dental Group . . . . .	935
Straumann Group . . . . .	906

#### IMPRESSION MATERIALS

3M . . . . .	1221
Advanced Materials Engineering Inc. . . . .	923
Align Technology . . . . .	1705
Coltene / SciCan . . . . .	2131
GC America Inc. . . . .	1521
Glidewell Dental. . . . .	1017
Hahn Implants. . . . .	1007
J. Morita USA . . . . .	1034
Kettenbach . . . . .	921
Power Dental Group . . . . .	935
Water Pik Inc. . . . .	1121

#### INFECTION CONTROL PRODUCTS

Air Techniques, Inc. . . . .	940
Atlanta Dental Supply . . . . .	1211
Benco Dental . . . . .	1641
BrandMax . . . . .	1040
Dentsply Sirona . . . . .	2002
Garrison Dental Solution. . . . .	1427
Hu-Friedy Mfg. Co., LLC . . . . .	1716
Kerr Dental . . . . .	2041
OSAP, Organization for Safety, Asepsis, and Prevention . . . . .	724
Preventech . . . . .	1517
Q-Optics & Quality Aspirators . . . . .	1140
Salvin Dental . . . . .	1104
Simply Hygiene . . . . .	1211
Top Quality Manufacturing . . . . .	1528
Tutttnauer USA Co., Ltd. . . . .	1341, 1441

## INSTRUMENTS, OPERATING & ACCESSORIES

Acteon North America . . . . .	1817
Bausch Articulating Papers . . . . .	1425
Best Instruments . . . . .	1041
Bioclear Matrix Systems . . . . .	1229
Brasseler USA . . . . .	1112
Dental Enterprises-Magnetic Mallet . . . . .	1330
Garrison Dental Solution . . . . .	1427
Golden Dent . . . . .	1135
Hu-Friedy Mfg. Co., LLC . . . . .	1716
Karl Schumacher Dental, LLC . . . . .	1941
PDT, Inc. . . . .	1631
Premier Dental Products Company . . . . .	1122
ProDentUSA . . . . .	801
Ritter Dental USA . . . . .	1511
Salvin Dental . . . . .	1104
Zoll-Dental . . . . .	1606
Zyris, creators of Isolite . . . . .	1346

## INSURANCE

Academy of General Dentistry . . . . .	700
Aflac Benefits Solutions . . . . .	1932
Anthem BlueCross Blue Shield . . . . .	1524
Delta Dental of TN, NC, SC, VA . . . . .	1620
Dental Office Support . . . . .	717
Doctors Disability Specialists . . . . .	1816
Doctors Disability Specialists . . . . .	830
eAssist Dental Solutions . . . . .	1131
GEHA Connection Dental Network . . . . .	1343
Georgia Dental Association . . . . .	843
Humana Dental . . . . .	1023
PracticeLife . . . . .	1211
PracticeProtection . . . . .	1143
Scratch Financial, Inc . . . . .	733

## INTERCOMMUNICATION SYSTEMS

Advantage Technologies . . . . .	1940
Black Diamond Radio . . . . .	1002
Kenwood / Two Way Radio Center . . . . .	1649
Porter Royal Sales . . . . .	920
YAPI . . . . .	721

## INTERDENTAL CLEANERS

Philips Sonicare and Zoom Whitening . . . . .	1905
Sunstar Americas, Inc.. . . . .	1226

## INTERNET SERVICES

Adit . . . . .	1349
Alatus Solutions . . . . .	833
Curve Dental . . . . .	1025, 1934
Digital Resource . . . . .	1445
Heartland Dental . . . . .	1721
ProSites . . . . .	913

## INTRA ORAL VIDEO SYSTEMS

Acteon North America . . . . .	1817
Align Technology . . . . .	1705
DentLight Inc. . . . .	1100
Sodium Dental. . . . .	827
Straumann Group . . . . .	906

## INVESTMENT MATERIALS & EQUIPMENT

Whip Mix Corporation. . . . .	713
-------------------------------	-----

## LABORATORY EQUIPMENT (not otherwise classified)

Dental Science Lab . . . . .	1243
DentalVibe / Bing Innovation . . . . .	2012
LabStore . . . . .	1211
NSK America . . . . .	1921
Panadent . . . . .	1133

## LASERS

Atlantic Dental Solutions . . . . .	1100
Biolase Technology, Inc.. . . . .	1325
Brasseler USA . . . . .	1112
CAO Group. . . . .	1910
DentLight Inc. . . . .	1100
Fotona. . . . .	1525
Henry Schein Dental. . . . .	1042
J. Morita USA . . . . .	1034
Medi Lazer. . . . .	820
ProBiora Health . . . . .	1914
Ultradent Products, Inc. . . . .	1621

## LIGHTS

A-dec . . . . .	1331
ADS Dental System Inc. . . . .	1031
Andau Medical . . . . .	2032
Aseptico. . . . .	1421
Brasseler USA . . . . .	1112
DCI Edge . . . . .	1821
Dental Equipment Liquidators, Inc.. . . . .	1702
Designs for Vision, Inc. . . . .	1115
LumaDent . . . . .	1601
Medi Loupes. . . . .	816
Orasoptic. . . . .	1605
Q-Optics & Quality Aspirators . . . . .	1140
Rose Micro Solutions . . . . .	1334, 1717
Snap On Optics . . . . .	1013
Zyris, creators of Isolite . . . . .	1346

## LOUPES

Andau Medical . . . . .	2032
Brasseler USA . . . . .	1112
Designs for Vision, Inc. . . . .	1115
LumaDent . . . . .	1601
Medi Loupes. . . . .	816
Orasoptic. . . . .	1605

Q-Optics & Quality Aspirators . . . . .	1140
Rose Micro Solutions . . . . .	1334, 1717
Snap On Optics . . . . .	1013
SurgiTel . . . . .	1635
Ultralight Optics . . . . .	934, 1101, 1548, 1840

## MASKS

Hu-Friedy Mfg. Co., LLC . . . . .	1716
Valumax International . . . . .	1234

## METAL RECOVERY, REFINING

Doral Refining Corp. . . . .	1424
Garfield Refining. . . . .	1235
Noble Metal Refining . . . . .	1129

## MICROSCOPES

Academy of Microscope Enhanced Dentistry. . . . .	1743
Rose Micro Solutions . . . . .	1334, 1717

## MIRRORS

A. Titan Instruments . . . . .	1035
PDT, Inc. . . . .	1631

## MOBILE DENTAL CLINIC

Christian Dental Society . . . . .	1908
------------------------------------	------

## MOUTHWASHES

Crest + Oral-B. . . . .	1411
OraCare . . . . .	1328
SuperMouth . . . . .	949
Water Pik Inc. . . . .	1121

## NITROUS OXIDE EQUIPMENT/SUPPLIES

Porter Royal Sales. . . . .	920
-----------------------------	-----

## OCCUSAL EXAM SYSTEMS/MATERIALS

Bausch Articulating Papers . . . . .	1425
Panadent . . . . .	1133
Whip Mix Corporation . . . . .	713

## OFFICE CONSTRUCTION & DESIGN

Atlanta Design Associates . . . . .	1211
Nashville Dental Inc. . . . .	1431

## OFFICE FURNITURE & DECOR

BQ Ergonomics . . . . .	1741
Nadia International, Inc. . . . .	1423
RGP, Inc. . . . .	1241

## OFFICE SUPPLIES

Black Diamond Radio . . . . .	1002
Kenwood / Two Way Radio Center . . . . .	1649
Wassaw Sound . . . . .	735

## ONLINE SERVICES

Academy of General Dentistry . . . . .	700
Adit . . . . .	1349
Alatus Solutions . . . . .	833
Dental Office Support . . . . .	717
Digital Resource . . . . .	1445
Firegang Dental Marketing . . . . .	2040
Heartland Dental . . . . .	1721
Lighthouse 360 . . . . .	1516
NexHealth . . . . .	931
Practice by Numbers . . . . .	1906
ProSites . . . . .	913
Scratch Financial, Inc . . . . .	733

## OPERATING LIGHTS

Beaverstate Dental, Inc. . . . .	1001
Dansereau Health Product . . . . .	904
Designs for Vision, Inc. . . . .	1115
SurgiTel . . . . .	1635

## OPERATING ROOM SUPPLIES & EQUIPMENT

(not otherwise classified)

Dental Enterprises-Magnetic Mallet . . . . .	1330
Nashville Dental Inc. . . . .	1431

## OPTICAL AIDS

Designs for Vision, Inc. . . . .	1115
Q-Optics & Quality Aspirators . . . . .	1140

## ORAL HYGIENE AIDS

Burst . . . . .	1833
CAO Group . . . . .	1910
Colgate . . . . .	805
NSK America . . . . .	1921
Philips Sonicare and Zoom Whitening . . . . .	1905
ProBiora Health . . . . .	1914
Simply Hygiene . . . . .	1211
Sunstar Americas, Inc. . . . .	1226

## ORAL IRRIGATION DEVICES

Burst . . . . .	1833
Water Pik Inc. . . . .	1121

## ORAL RINSES

Colgate . . . . .	805
-------------------	-----

## ORAL SCREENING DEVICE

Atlantic Dental Solutions . . . . .	1100
DentLight Inc. . . . .	1100
Direct Diagnostics . . . . .	1917

## ORTHODONTIC/PEDODONTIC MATERIALS

Align Technology . . . . .	1705
ClearCorrect . . . . .	906
Dentsply Sirona . . . . .	2002
Preventech . . . . .	1517

## PATIENT FINANCING

Alatus Solutions . . . . .	833
Alphaeon Credit . . . . .	932
CareCredit - Synchrony . . . . .	1729
Momnt . . . . .	1016
Scratch Financial, Inc . . . . .	733
Sunbit . . . . .	815

## PERIODICALS, PROFESSIONAL/SCIENTIFIC

Georgia Dental Hygienists' Association . . . . .	730
--	-----

## PERIODONTAL DIAGNOSTIC PRODUCTS

Direct Diagnostics . . . . .	1917
Power Dental Group . . . . .	935

## PERIODONTAL EXAM SYSTEMS, COMPUTERIZED

Florida Probe VoiceWorks . . . . .	1715
------------------------------------	------

## PERIODONTAL INSTRUMENTS & SUPPLIES

A. Titan Instruments . . . . .	1035
Acteon North America . . . . .	1817
Hu-Friedy Mfg. Co., LLC . . . . .	1716
Karl Schumacher Dental, LLC . . . . .	1941
PDT, Inc. . . . .	1631
Power Dental Group . . . . .	935
Salvin Dental . . . . .	1104
Zoll-Dental . . . . .	1606

## PIT & FISSURE SEALANTS

Elevate Oral Care . . . . .	1522
Premier Dental Products Company . . . . .	1122
Pulpdent Corporation . . . . .	1507
Shofu Dental Corporation . . . . .	1324
Ultradent Products, Inc. . . . .	1621
VOCO America, Inc. . . . .	905

## PLAQUE & GINGIVITIS MOUTH RINSES

ProBiora Health . . . . .	1914
---------------------------	------

## POLISHING SYSTEMS

Bioclear Matrix Systems . . . . .	1229
NSK America . . . . .	1921
Prophy Magic . . . . .	1020
Vector Research & Development . . . . .	1100

## PORCELAIN PRODUCTS & ACCESSORIES

Bisco . . . . .	1021
Shofu Dental Corporation . . . . .	1324

## PORTABLE DELIVERY SYSTEMS

Aseptico . . . . .	1421
Christian Dental Society . . . . .	1908

## PRACTICE MANAGEMENT

Academy of General Dentistry . . . . .	700
Adit . . . . .	1349
Atlanta Dental Supply . . . . .	1211
BridgeWay Practice Transitions . . . . .	1124
CareCredit - Synchrony . . . . .	1729
Carestream Dental . . . . .	1529
CARR / Dental Real Estate . . . . .	1147
Coast Dental & Orthodontics . . . . .	714
Curve Dental . . . . .	1025, 1934
D4C Dental Brands . . . . .	1901
Dental Office Support . . . . .	717
eAssist Dental Solutions . . . . .	1131
Firegang Dental Marketing . . . . .	2040
Four Quadrants Advisory . . . . .	814
Heartland Dental . . . . .	1721
Kleer . . . . .	813
Lighthouse 360 . . . . .	1516
McGill & Hill Group . . . . .	1520
McLerran & Associates . . . . .	734
NexHealth . . . . .	931
Oak Dental Partners . . . . .	1904
PNC Healthcare Business Banking . . . . .	1912
Practice by Numbers . . . . .	1906
PracticeLife . . . . .	1211
RecallMax . . . . .	1233
Sage Dental . . . . .	1141
Solutionreach . . . . .	1730
Southern Family Dental Partners . . . . .	741
Star Dental Partners . . . . .	1010
Sunbit . . . . .	815
YAPI . . . . .	721

## PRACTICE MARKETING

Adit . . . . .	1349
Alatus Solutions . . . . .	833
Birdeye . . . . .	1004
Clipper Magazine . . . . .	1344
Digital Resource . . . . .	1445
Ditron Dental USA . . . . .	2031
Dr. Marketing . . . . .	926
Firegang Dental Marketing . . . . .	2040
GLO Science Professional . . . . .	1447
GrowthPlug, Inc. . . . .	725
Heartland Dental . . . . .	1721
Kleer . . . . .	813
McLerran & Associates . . . . .	734
ProSites . . . . .	913
Sage Dental . . . . .	1141
SGA Dental Partners . . . . .	807
Solutionreach . . . . .	1730

## PRACTICE SALES

Adit . . . . .	1349
ADS South . . . . .	1326
AFTCO Transition Consultants . . . . .	1006
Bank of America Practice Solutions . . . . .	1441
BridgeWay Practice Transitions . . . . .	1124
Cain, Watters & Associates . . . . .	1713
CARR / Dental Real Estate . . . . .	1147
Choice Transitions, LLC . . . . .	720
D4C Dental Brands . . . . .	1901
DDS Match South LLC . . . . .	1841
Doctors Disability Specialists . . . . .	1816
Four Quadrants Advisory . . . . .	814
GLO Science Professional . . . . .	1447
Heartland Dental . . . . .	1721
Henry Schein Dental Practice Transitions . . . . .	1014
Kleer . . . . .	813
McGill & Hill Group . . . . .	1520
McLerran & Associates . . . . .	734
PNC Healthcare Business Banking . . . . .	1912
PPM - Professional Practice Management . . . . .	1211
Solutionreach . . . . .	1730
Star Dental Partners . . . . .	1010
Sunbit . . . . .	815
Wells Fargo Practice Finance . . . . .	1613

## PREVENTIVE DENTISTRY PRODUCTS

3M . . . . .	1221
Burst . . . . .	1833
Elevate Oral Care . . . . .	1522
Florida Probe VoiceWorks . . . . .	1715
GC America Inc. . . . .	1521
Ivoclar . . . . .	1321
Kilgore International, Inc. . . . .	1534
NSK America . . . . .	1921
Premier Dental Products Company . . . . .	1122
Preventech . . . . .	1517
ProBiora Health . . . . .	1914
Prophy Magic . . . . .	1020
Pulpdent Corporation . . . . .	1507
Simply Hygiene . . . . .	1211
Sunstar Americas, Inc. . . . .	1226

## PROPHYLAXIS ANGLES & KITS

Medidenta / Prophy Magic . . . . .	1020
Premier Dental Products Company . . . . .	1122
Preventech . . . . .	1517
Prophy Magic . . . . .	1020
Simply Hygiene . . . . .	1211
Water Pik Inc. . . . .	1121

## PROSTHETIC & LABORATORY SUPPLIES

[not otherwise classified]

Dandy Dental Lab . . . . .	1243
LabStore . . . . .	1211

## PROTECTIVE COVERINGS

Halyard Global Products . . . . .	1430
-----------------------------------	------

## PUBLICATIONS

Academy of General Dentistry . . . . .	700
Clipper Magazine . . . . .	1344
Dental Tribune . . . . .	722
Dentistry Today . . . . .	1024
DEW . . . . .	1930
McGill & Hill Group . . . . .	1520

## RECORD KEEPING SYSTEMS

Kleer . . . . .	813
Lighthouse 360 . . . . .	1516
NexHealth . . . . .	931

## REFINERIES

Doral Refining Corp. . . . .	1424
Garfield Refining . . . . .	1235
Zoll - Dental . . . . .	1606

## RESTORATIVE MATERIALS & ACCESSORIES

[not otherwise classified]

3M . . . . .	1221
Bioclear Matrix Systems . . . . .	1229
Bisco . . . . .	1021
Brasseler USA . . . . .	1112
Common Sense Dental Products . . . . .	1711
Dentsply Sirona . . . . .	2002
GC America Inc. . . . .	1521
Golden Dent . . . . .	1135
Kerr Dental . . . . .	2041
Nashville Dental Inc. . . . .	1431
NSK America . . . . .	1921
Panadent . . . . .	1133
Pulpdent Corporation . . . . .	1507
Shofu Dental Corporation . . . . .	1324
Top Quality Manufacturing . . . . .	1528
Water Pik Inc. . . . .	1121

## RETRACTION DEVICES

Karl Schumacher Dental, LLC . . . . .	1941
PDT, Inc. . . . .	1631
Zyris, creators of Isolite . . . . .	1346

## SCALING/STAIN REMOVAL DEVICES

Atlantic Dental Solutions . . . . .	1100
Medidenta / Prophy Magic . . . . .	1020
NSK America . . . . .	1921
Prophy Magic . . . . .	1020
Vector Research & Development . . . . .	1100

Water Pik Inc. . . . .	1121
Zoll-Dental . . . . .	1606

## SHARPENING SYSTEMS

PDT, Inc. . . . .	1631
Simply Hygiene . . . . .	1211

## SLEEP/AIRWAY DEVICES

Kettenbach . . . . .	921
Vivos Therapeutics . . . . .	2034

## STAFFING SERVICES

Alatus Solutions . . . . .	833
BridgeWay Practice Transitions . . . . .	1124
Cloud Dentistry . . . . .	1026
DDS Match South LLC . . . . .	1841
Dental Dynamic Staffing . . . . .	1831
Dental Office Support . . . . .	717
Star Dental Partners . . . . .	1010
Wassaw Sound . . . . .	735

## STERILIZER ACCESSORIES

Coltene / SciCan . . . . .	2131
PDT, Inc. . . . .	1631
Tuttner USA Co., Ltd. . . . .	1341

## STERILIZERS

Best Instruments . . . . .	1041
Coltene / SciCan . . . . .	2131
Dental Equipment Liquidators, Inc. . . . .	1702
Midmark Corporation . . . . .	1107
Porter Royal Sales . . . . .	920
Tuttner USA Co., Ltd. . . . .	1341

## STERILIZING & DISINFECTING SOLUTIONS

Coltene / SciCan . . . . .	2131
Hu-Friedy Mfg. Co., LLC . . . . .	1716
Tuttner USA Co., Ltd. . . . .	1341

## STOOLS, DENTAL OPERATING

A-dec . . . . .	1331
ADS Dental System Inc. . . . .	1031
Aseptico . . . . .	1421
Beaverstate Dental, Inc. . . . .	1001
Benco Dental . . . . .	1641
BQ Ergonomics . . . . .	1741
Dansereau Health Product . . . . .	904
DCI Edge . . . . .	1821
Midmark Corporation . . . . .	1107
Porter Royal Sales . . . . .	920
Professional Sales Associates, Inc. . . . .	1341
RGP, Inc. . . . .	1241
Ritter Dental USA . . . . .	1511
SurgiTel . . . . .	1635

## STOOLS, LABORATORY

BQ Ergonomics . . . . .	1741
RGP, Inc. . . . .	1241
Simply Hygiene . . . . .	1211

## SURGICAL SUPPLIES

Best Instruments . . . . .	1041
CAO Group . . . . .	1910
Dental Enterprises-Magnetic Mallet . . . . .	1330
Hu-Friedy Mfg. Co., LLC . . . . .	1716
Power Dental Group . . . . .	935
Salvin Dental . . . . .	1104
Zoll-Dental . . . . .	1606

## SYRINGES, ALL TYPES

Best Instruments . . . . .	1041
Karl Schumacher Dental, LLC . . . . .	1941
Prophy Magic . . . . .	1020

## TEETH, ARTIFICIAL

Kilgore International, Inc. . . . .	1534
LabStore . . . . .	1211

## TMJ PRODUCTS

Dandy . . . . .	1624
Panadent . . . . .	1133

## TOOTH SHADE GUIDES

Glidewell Dental . . . . .	1017
GLO Science Professional . . . . .	1447
Hahn Implants . . . . .	1007
Video Dental Concepts . . . . .	1604

## TOOTH WHITENING

BSolve Dental . . . . .	1132
Burst . . . . .	1833
CAO Group . . . . .	1910
Colgate . . . . .	805
Crest + Oral-B . . . . .	1411
GLO Science Professional . . . . .	1447
Premier Dental Products Company . . . . .	1122
Preventech . . . . .	1517
ProBiora Health . . . . .	1914
Ultradent Products, Inc. . . . .	1621

## TOOTHBRUSHES, HAND

Church & Dwight / Arm & Hammer . . . . .	1121
Colgate . . . . .	805
Crest + Oral-B . . . . .	1411
Simply Hygiene . . . . .	1211
Sunstar Americas, Inc.. . . . .	1226
SuperMouth . . . . .	949
Water Pik Inc. . . . .	1121

## TOOTHBRUSHES, POWER

Burst . . . . .	1833
Church & Dwight / Arm & Hammer . . . . .	1121
Crest + Oral-B . . . . .	1411
Philips Sonicare and Zoom Whitening . . . . .	1905
Sodium Dental . . . . .	827
Sunstar Americas, Inc.. . . . .	1226
SuperMouth . . . . .	949
Water Pik Inc. . . . .	1121

## TOYS & NOVELTIES

SuperMouth . . . . .	949
----------------------	-----

## ULTRASONIC EQUIPMENT, LABORATORY

BrandMax . . . . .	1040
Tuttnauer USA Co., Ltd. . . . .	1341

## ULTRASONIC EQUIPMENT, PROPHYLAXIS

Medidenta / Prophy Magic . . . . .	1020
Tuttnauer USA Co., Ltd. . . . .	1341

## UNIFORMS & GOWNS

Valumax International . . . . .	1234
---------------------------------	------

## VACUUM SYSTEMS

ADS Dental System Inc. . . . .	1031
Air Techniques, Inc. . . . .	940
Atlantic Dental Solutions . . . . .	1100
Dansereau Health Product . . . . .	904
Dental Equipment Liquidators, Inc.. . . . .	1702
DENTALEZ . . . . .	1341
Professional Sales Associates, Inc. . . . .	1341
Sunrise Dental Equipment, Inc. . . . .	1540

## WAX, ALL TYPES

Whip Mix Corp. . . . .	713
------------------------	-----

## WEBSITE DESIGN

Adit . . . . .	1349
Alatus Solutions . . . . .	833
Birdeye . . . . .	1004
DDS Multimedia . . . . .	1634
Digital Resource . . . . .	1445
Doctor Multimedia . . . . .	941
Dr. Marketing . . . . .	926
GrowthPlug, Inc.. . . . .	725

## XEROSTOMIA PRODUCTS

Elevate Oral Care . . . . .	1522
-----------------------------	------

## X-RAY DIGITAL

Acteon North America . . . . .	1817
Air Techniques, Inc. . . . .	940
American SensorTech . . . . .	1043
Atlanta Dental Supply . . . . .	1211
Carestream Dental . . . . .	1529
Curve Dental . . . . .	1025, 1934
Digital Doc, LLC . . . . .	1000
Henry Schein Dental . . . . .	1042
J. Morita USA . . . . .	1034
Midmark Corporation . . . . .	1107
Nashville Dental Inc. . . . .	1431
Patterson Dental Supply, Inc. . . . .	1622
Planmeca USA, Inc. . . . .	1315
Sodium Dental . . . . .	827
Vatech America . . . . .	1712
Video Dental Concepts . . . . .	1604

## X-RAY FILMS, INTRA ORAL & EXTRA ORAL

Biolase . . . . .	1325
Vatech America . . . . .	1712

## X-RAY MACHINES & ACCESSORIES

Acteon North America . . . . .	1817
Air Techniques, Inc. . . . .	940
American SensorTech . . . . .	1043
Aseptico . . . . .	1421
Atlanta Dental Supply . . . . .	1211
Atlantic Dental Solutions . . . . .	1100
Benco Dental . . . . .	1641
Biolase Technology, Inc.. . . . .	1325
Dental Equipment Liquidators, Inc.. . . . .	1702
Dental Science Lab . . . . .	1243
Henry Schein Dental . . . . .	1042
Patterson Dental Supply, Inc. . . . .	1622
Planmeca USA, Inc. . . . .	1315
Sodium Dental . . . . .	827
Sunrise Dental Equipment, Inc. . . . .	1540
Vatech America . . . . .	1712
Vector Research & Development . . . . .	1100
Video Dental Concepts . . . . .	1604

## X-RAY PROCESSING EQUIPMENT & ACCESSORIES

American SensorTech . . . . .	1043
Biolase Technology, Inc.. . . . .	1325
Microcopy . . . . .	1825
Vatech America . . . . .	1712

# EXHIBITOR *Listing*

3M . . . . .	1221	Brain Bytes Creative . . . . .	743	Dental Tribune . . . . .	722
A. Titan Instruments . . . . .	1035	BrandMax . . . . .	1040	Power Dental Group . . . . .	935
Academy of General Dentistry . . . . .	700	Brasseler USA . . . . .	1112	DENTALEZ . . . . .	1341
Academy of Microscope Enhanced Dentistry	1743	BridgeWay Practice Transitions . . . . .	1124	DentalVibe / Bing Innovation. . . . .	2012
Accelerated Dental Assisting Academy. . . . .	1342	BSolve Dental . . . . .	1132	Dentistry Today . . . . .	1024
Accutron, a member of HuFriedy Group. . . . .	1341	Burst . . . . .	1833	DentLight Inc. . . . .	1100
Acteon North America . . . . .	1817	Cain, Watters & Associates . . . . .	1713	Dentsply Sirona . . . . .	2002
ADA Practice Transitions . . . . .	704	CareCredit - Synchrony . . . . .	1729	Designs for Vision, Inc. . . . .	1115
Adako USA . . . . .	1815	Carestream Dental. . . . .	1529	Digital Doc, LLC . . . . .	1000
A-dec . . . . .	1331	CARR / Dental Real Estate. . . . .	1147	Digital Resource . . . . .	1445
Adit . . . . .	1349	Centers for Disease Control and Prevention	726	Digital Technology Partners . . . . .	840
ADS Dental System Inc. . . . .	1031	Centurion Health . . . . .	845	Digital Healthcare Professionals . . . . .	1827
ADS South. . . . .	1326	Choice Transitions, LLC . . . . .	720	Direct Diagnostics . . . . .	1917
Advanced Materials Engineering Inc. . . . .	923	Christian Dental Society . . . . .	1908	Ditron Dental USA . . . . .	2031
Advantage Technologies . . . . .	1940	Church & Dwight / Arm & Hammer . . . . .	1121	Doctible . . . . .	1148
Affinity Bank . . . . .	1640	ClearCorrect. . . . .	906	Doctor's Choice Practice Transitions . . . . .	915
Aflac Benefits Solutions . . . . .	1932	Clipper Magazine . . . . .	1344	Doctors Disability Specialists . . . . .	1816
AFTCO Transition Consultants . . . . .	1006	Cloud Dentistry . . . . .	1026	Doctors Disability Specialists . . . . .	830
Air Techniques, Inc. . . . .	940	Coast Dental & Orthodontics . . . . .	714	Doral Refining Corp. . . . .	1424
Airway Health Solutions . . . . .	2033	Colgate . . . . .	805	Dr. Marketing . . . . .	926
Alatus Solutions. . . . .	833	Colony Bank . . . . .	917	Dreve America Corporation. . . . .	1145
Alphaeon Credit . . . . .	932	Common Sense Dental Products . . . . .	1711	eAssist Dental Solutions. . . . .	1131
CAO Group. . . . .	1910	Core Scientific. . . . .	1543	EdgeDental Specialties . . . . .	1805
American Academy for Oral & Systemic Health	1915	CR Foundation Gordon J. Christensen		Elevate Oral Care . . . . .	1522
American SensorTech . . . . .	1043	Clinicians Report . . . . .	1227	Enova Illumination. . . . .	1920
Andau Medical . . . . .	2032	Crest + Oral-B . . . . .	1411	EOS Market Intelligence . . . . .	1012
Anthem BlueCross Blue Shield . . . . .	1524	Crown Tenant Advisors. . . . .	1134	Equitable-ADA Members Retirement Program	1902
Arch Financial Planning, LLC . . . . .	1449	Crown World Dental Lab . . . . .	1526	Evenly Technologies . . . . .	1814
Aseptic. . . . .	1421	Curve Dental . . . . .	1025, 1934	Firegang Dental Marketing . . . . .	2040
Atlanta Dental Supply . . . . .	1211	Cutco Cutlery . . . . .	2035	First Citizens Bank. . . . .	740
Atlanta Design Associates . . . . .	1211	Dandy. . . . .	1624	Florida Probe VoiceWorks . . . . .	1715
Atlantic Dental Solutions . . . . .	1100	Dansereau Health Product . . . . .	904	Fotona. . . . .	1525
Augma Biomaterials USA. . . . .	811	DCI Edge . . . . .	1821	Four Quadrants Advisory . . . . .	814
Bank of America Practice Solutions . . . . .	1441	DDS Match South LLC . . . . .	1841	Garfield Refining. . . . .	1235
Barclay Water Management . . . . .	742	DDS Multimedia . . . . .	1634	Garrison Dental Solution. . . . .	1427
Bausch Articulating Papers . . . . .	1425	Doctor Multimedia. . . . .	941	GC America Inc. . . . .	1521
Beaverstate Dental, Inc. . . . .	1001	Delmore. . . . .	1246	GEHA Connection Dental Network . . . . .	1343
Benco Dental . . . . .	1641	Delta Dental of TN, NC, SC, VA . . . . .	1620	Georgia Dental Association . . . . .	843
Best Instruments . . . . .	1041	Dental Acquisition Group. . . . .	732	Georgia Dental Hygienists' Association . . . . .	730
Bioclear Matrix Systems . . . . .	1229	DANB and the DALE Foundation. . . . .	715	Glidewell Dental. . . . .	1017
BioGaia Probiotics . . . . .	710	Dental Dynamic Staffing . . . . .	1831	Hahn Implants. . . . .	1007
Biolase Technology, Inc. . . . .	1325	Dental Enterprises-Magnetic Mallet . . . . .	1330	GLO Science Professional . . . . .	1447
Birdeye . . . . .	1004	DEW. . . . .	1930	Global Dental Relief . . . . .	832
Bisco Inc. . . . .	1021	Dental Equipment Liquidators, Inc. . . . .	1702	Global Fantasy. . . . .	751
Black Diamond Radio . . . . .	1002	Dental Intelligence . . . . .	1810	Golden Dent. . . . .	1135
Black Talon Security, LLC . . . . .	927	Dental Lifeline Network . . . . .	731	Gordon J. Christensen - Practical Clinical Courses	1225
BoomCloud . . . . .	1745	Dental Office Support . . . . .	717	Greater New York Dental Meeting . . . . .	1130
BQ Ergonomics . . . . .	1741	Dental Science Lab . . . . .	1243	GrowthPlug, Inc. . . . .	725



Gwinnett Drugs Compounding Pharmacy . . .	1811	Noble Metal Refining . . . . .	1129	Snap On Optics . . . . .	1013
Bien-Air / Hager Worldwide . . . . .	2001	NSK America . . . . .	1921	Sodium Dental. . . . .	827
Haleon . . . . .	2016	Oak Dental Partners . . . . .	1904	Solutionreach . . . . .	1730
Heartland Dental . . . . .	1721	Onpharma Company . . . . .	1448	Southern Dental Alliance . . . . .	944
Henry Schein Dental . . . . .	1042	OraCare . . . . .	1328	Southern Family Dental Partners . . . . .	741
Henry Schein Dental Practice Transitions . . . . .	1014	Orascope. . . . .	1605	SS White Dental. . . . .	1417
Hiossen, Inc. . . . .	1228	Orthosnap Corp . . . . .	831	Star Dental Partners . . . . .	1010
Hu-Friedy Mfg. Co., LLC . . . . .	1716	OSAP, Organization for Safety, Asepsis, and Prevention . . . . .	724	Sterilizer Autoclave Solutions . . . . .	911
Humana Dental . . . . .	1023	Halyard Products . . . . .	1644	Strategic Tax Planning . . . . .	1544
Hunza Dental . . . . .	1900	Panadent . . . . .	1133	Straumann . . . . .	906
Impladent Ltd.. . . . .	1332	Patterson Dental Supply, Inc. . . . .	1622	Straumann Group . . . . .	906
International Medical Relief . . . . .	2014	PDT, Inc. . . . .	1631	Summus Medical Laser . . . . .	825
Align Technology . . . . .	1705	Philips Sonicare and Zoom Whitening . . . . .	1905	Sunbit. . . . .	815
Iotech International . . . . .	1005	PLANMECA USA, Inc.. . . . .	1315	Sunrise Dental Equipment, Inc . . . . .	1540
Ivoclar . . . . .	1321	PNC Healthcare Business Banking . . . . .	1912	Sunstar Americas, Inc. . . . .	1226
J. Morita USA . . . . .	1034	Powered Living . . . . .	2003	SuperMouth . . . . .	949
Jeunesse Innovations . . . . .	812	PPM- Professional Practice Management . . . . .	1211	SurgiTel . . . . .	1635
KaVo . . . . .	1748	Practice by Numbers. . . . .	1906	Wellnext Group . . . . .	834
Kenwood / Two Way Radio Center . . . . .	1649	Practice Pathways - Zions Bank . . . . .	728	Tempmee . . . . .	1946
Kerr Dental . . . . .	2041	PracticeLife . . . . .	1211	The Argen Corporation . . . . .	1646
Kettenbach . . . . .	921	PracticeProtection . . . . .	1143	The Dentist's Choice . . . . .	1813
Kilgore International, Inc. . . . .	1534	Premier Dental Products Company . . . . .	1122	The Gideons International . . . . .	1942
Kleer . . . . .	813	Preventech . . . . .	1517	Huntington Bank Practice Finance . . . . .	1033
Komet . . . . .	1240	ProBiora Health . . . . .	1914	The Pankey Institute . . . . .	723
LabStore . . . . .	1211	ProDentUSA . . . . .	801	TheraBreath . . . . .	1121
FiteBac Dental. . . . .	802	Professional Sales Associates, Inc. . . . .	1341	Tokuyama America . . . . .	822
Lasso MD . . . . .	1747	Prophy Magic . . . . .	1020	Top Quality Manufacturing . . . . .	1528
LendingPoint . . . . .	1943	ProSites . . . . .	913	Tuttner USA Co., Ltd. . . . .	1341
Leon Global Group LLC . . . . .	930, 1916	Prospa Billing . . . . .	1944	Ultradent Products, Inc. . . . .	1621
Lighthouse 360 . . . . .	1516	Provide . . . . .	1628	Ultralight Optics . . . . .	934, 1101, 1548, 1840
Listerine . . . . .	706	Pulpdent Corporation . . . . .	1507	United Community Bank . . . . .	841
LumaDent . . . . .	1601	PureLife Dental . . . . .	1632	UpSwell Marketing. . . . .	2030
Mango Voice. . . . .	1935	Q-Optics & Quality Aspirators . . . . .	1140	Vakker Dental Inc. . . . .	821
McGill & Hill Group. . . . .	1520	Ray America . . . . .	1242	Valumax International . . . . .	1234
McLerran & Associates. . . . .	734	RecallMax. . . . .	1233	Vatech America . . . . .	1712
Medi Lazer. . . . .	820	RevenueWell + PBHS . . . . .	1931	Vector Research & Development . . . . .	1100
Medi Loupes . . . . .	816	RGP, Inc. . . . .	1241	Video Dental Concepts. . . . .	1604
Medical Missions Outreach. . . . .	943	Ritter Dental USA . . . . .	1511	Vivos Therapeutics . . . . .	2034
Medidenta / Prophy Magic . . . . .	1020	DGSHAPE, A Roland Company . . . . .	1442	VOCO America, Inc. . . . .	905
MedTech International Group. . . . .	800	Rose Micro Solutions . . . . .	1334, 1717	N3Sleep / Voxel Dental . . . . .	1809
Microcopy . . . . .	1825	Porter Royal Sales . . . . .	920	Walmart Health . . . . .	1049
Midmark Corporation. . . . .	1107	Sage Dental . . . . .	1141	Wassaw Sound . . . . .	735
Modular & Custom Cabinets . . . . .	1341	Salvin Dental . . . . .	1104	Water Pik Inc. . . . .	1121
Momnt . . . . .	1016	Karl Schumacher Dental, LLC . . . . .	1941	Weave. . . . .	705
Mortenson Dental Partners. . . . .	1127	Coltene / SciCan . . . . .	2131	Wells Fargo Practice Finance. . . . .	1613
Nadia International, Inc. . . . .	1423	Scratch Financial, Inc . . . . .	733	Whip Mix Corporation . . . . .	713
Nashville Dental Inc. . . . .	1431	SGA Dental Partners . . . . .	807	Xlear, Inc.. . . . .	1913
National Dental Association . . . . .	945	Shofu Dental Corporation . . . . .	1324	YAPI. . . . .	721
Neodent . . . . .	906	Simply Hygiene . . . . .	1211	ZOLL Medical Corporation . . . . .	1429
New Image Dental Laboratory . . . . .	1541	Slate Electric Flosser . . . . .	1633	Zoll-Dental . . . . .	1606
NexHealth . . . . .	931	D4C Dental Brands. . . . .	1901	Zyris, creators of Isolite . . . . .	1346
Nobio / Infinix . . . . .	925				

# EXPAND YOUR HORIZONS EVEN FURTHER.

## Explore additional CE opportunities.

The below one-hour courses are \$35 per course for registered in-person attendees and \$50 per course for virtual-only registrants. Log in to your Hinman registration account to add these courses. Courses available through May 31, 2023. Complete the five-question quiz and survey at the conclusion of the course to obtain your CE certificate.

SPEAKER	TITLE	COURSE #
Dr. Mark Murphy	Is Going Non Par the Right Move for YOU	Vr600
Ms. Nancy Dewhirst	Right Under Our Noses...Emerging & Re-Emerging Diseases	Vr601
Dr. Alan Budenz	Prevention and Minimally-Invasive Dentistry: Diminishing the Role of the Dental Drill	Vr602
Dr. James Braun	Let's Put It All Together: The Best Materials for Direct Composite Restorations	Vr603
Dr. Gordon Christensen	Getting Prepared for Future Dentistry	Vr604
Dr. Megan King	The Future of Endodontic Care	Vr605
Dr. Laura Braswell	Laser Periodontics To Enhance Optimal Patient Care	Vr606
Dr. Kevin Kwiecien	Health-Centered Dentistry in the Digital Age	Vr607
Dr. Clayton Davis	Lab Communication in a World Transitioning from Analog to Digital	Vr608
Mr. Brandon Collier	An Aggressive but Legal Approach to Taxes, With 2023 Updates	Vr609
Ms. Laci Phillips Newland	Creating New Perspectives & Opportunities: How to Explore Your Horizons and Expand Your Future in the Dental Practice	Vr610
Dr. Mark Kleive	Utilizing 3D Printing and Other Digital Integration in General Dentistry	Vr611
Dr. Wayne Kerr	How to Get to Life After Dr.	Vr612
Dr. Dan Dunwody	Outside In Facial and Oral Examination: A Key to Optimal Health	Vr613
Ms. Jo-Anne Jones	Xerostomia: Etiology, Evaluation, and Innovative Strategies to Treat	Vr614
Dr. Parag Kachalia	Overview of New Technologies with a Clear ROI	Vr615



After you add the course to your registration account, head to <https://www.prereg.net/2023/hd-virtual/> to view the course and obtain your CE certificate.

# Thank you to our partners



Dental Enterprises, LLC



Dr. Marketing



MORITA



Thank you to the following companies for providing supplies for our educational program:

ACTEON North America - Booth 1817  
Atlanta Dental Supply - Booth 1211  
Bioclear Matrix Systems - Booth 1229  
Biolase Technology, Inc. - Booth 1325  
Brasseler USA - Booth 1112  
Dentsply Sirona Suresmile  
and Endodontics - Booth 2002  
Fotona - Booth 1525  
Garrison Dental Solution - Booth 1427

GC America Inc. - Booth 1521  
Henry Schein Dental - Booth 1042  
Ivoclar - Booth 1321  
Kettenbach - Booth 921  
Kilgore International, Inc. - Booth 1234  
Komets - Booth 1240  
Panadent - Booth 1133  
Ultradent Products, Inc. - Booth 1621  
Vatech America - Booth 1721  
Whip Mix Corporation - Booth 713

NEW!



# VALO™ X

THE CURING LIGHT REIMAGINED



VISIT US AT BOOTH #1621